

THE CONTENTS OF THIS DRAWING ARE THE EXCLUSIVE PROPERTY OF THE TECHNICAL MATERIEL CORP. ITS UNAUTHORIZED USE OR REPRODUCTION IN WHOLE OR IN PART IS STRICTLY FORBIDDEN.

REQ. PER UNIT 2	USED ON		PX-711	0
	MODEL GPT-200K	ASS'Y. NO. AS-123		

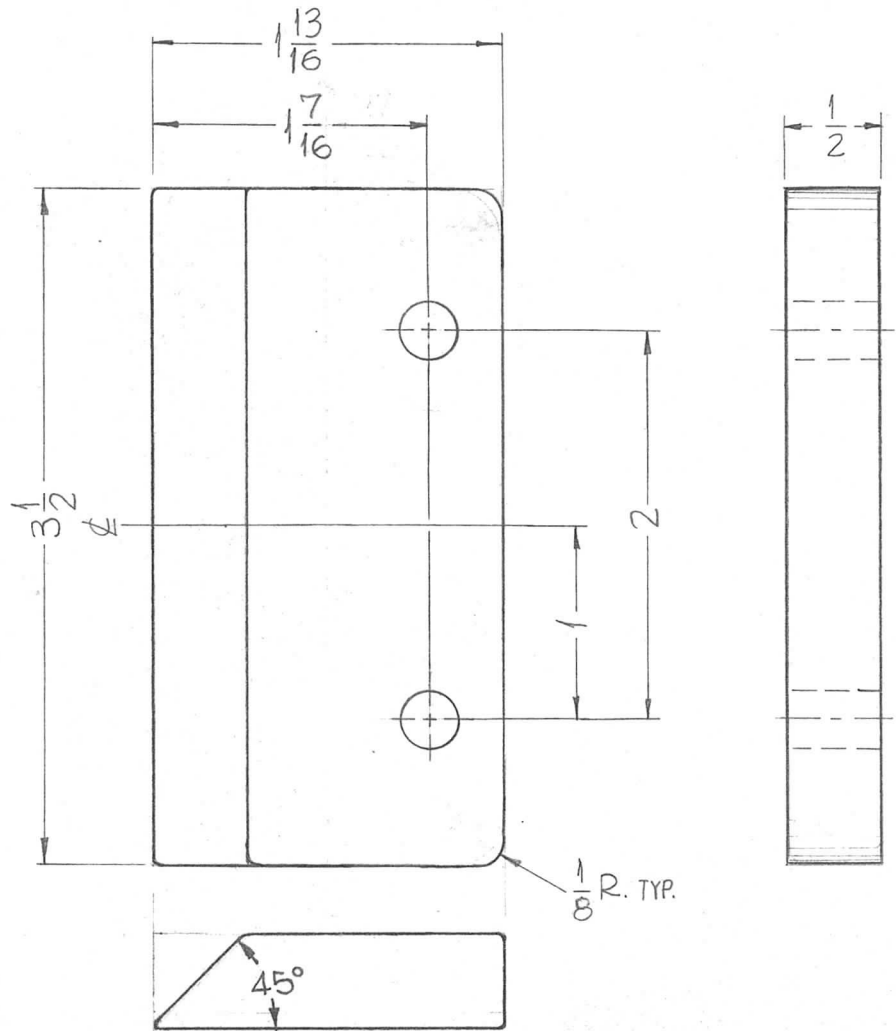

HOLES
9/32 DIA. (2 REQ.)

NOTE
UNLESS OTHERWISE SPECIFIED
USE 1/32 RAD. ON ALL CORNERS
& EDGES.

REQ.	ITEM	PART NO.	F. BUDETTI			DESCRIPTION	SYMBOL
		1/2 THICK	THE TECHNICAL MATERIEL CORP.			MAMARONECK, NEW YORK	
		STOCK SIZE	G7 SILICON GLASS			SPACER, BANDSWITCH	
0	ORIGINAL RELEASE	5.16.64	ASB				
SYM	DESCRIPTION	DATE	CH. NO.	DRAFTS	CHECKER	ENG. APP.	
UNLESS OTHERWISE SPECIFIED: DIMENSIONS ARE IN INCHES TOLERANCES ON FRAC. ± 1/64 DEC. ± .005 ANGLES ± 1/2°		SCALE: MAXIMUM ALLOWABLE TOLERANCES HAVE BEEN DETERMINED AND ANY DEVIATIONS WILL BE CAUSE FOR REJECTION. REMOVE ALL BURRS AND SHARP EDGES		SRG		aa AB RCL	
		TYPE & TEMPER	HEAT TREAT. SPEC.	DRAWN	CHECKED	FINAL APPROVAL	
		FINISH & SPEC. NO.		ELEC. DES. APP. MECH. DES. APP.		PX-711	0