

THE CONTENTS OF THIS DRAWING ARE THE EXCLUSIVE PROPERTY OF THE TECHNICAL MATERIEL CORP. ITS UNAUTHORIZED USE FOR REPRODUCTION IN WHOLE OR IN PART IS STRICTLY FORBIDDEN.

REQ. PER UNIT	USED ON			PO 260	Ø
	MODEL	ASS'Y. NO.	DATE		
1	RAK 21	MS 3099	9-30-65		

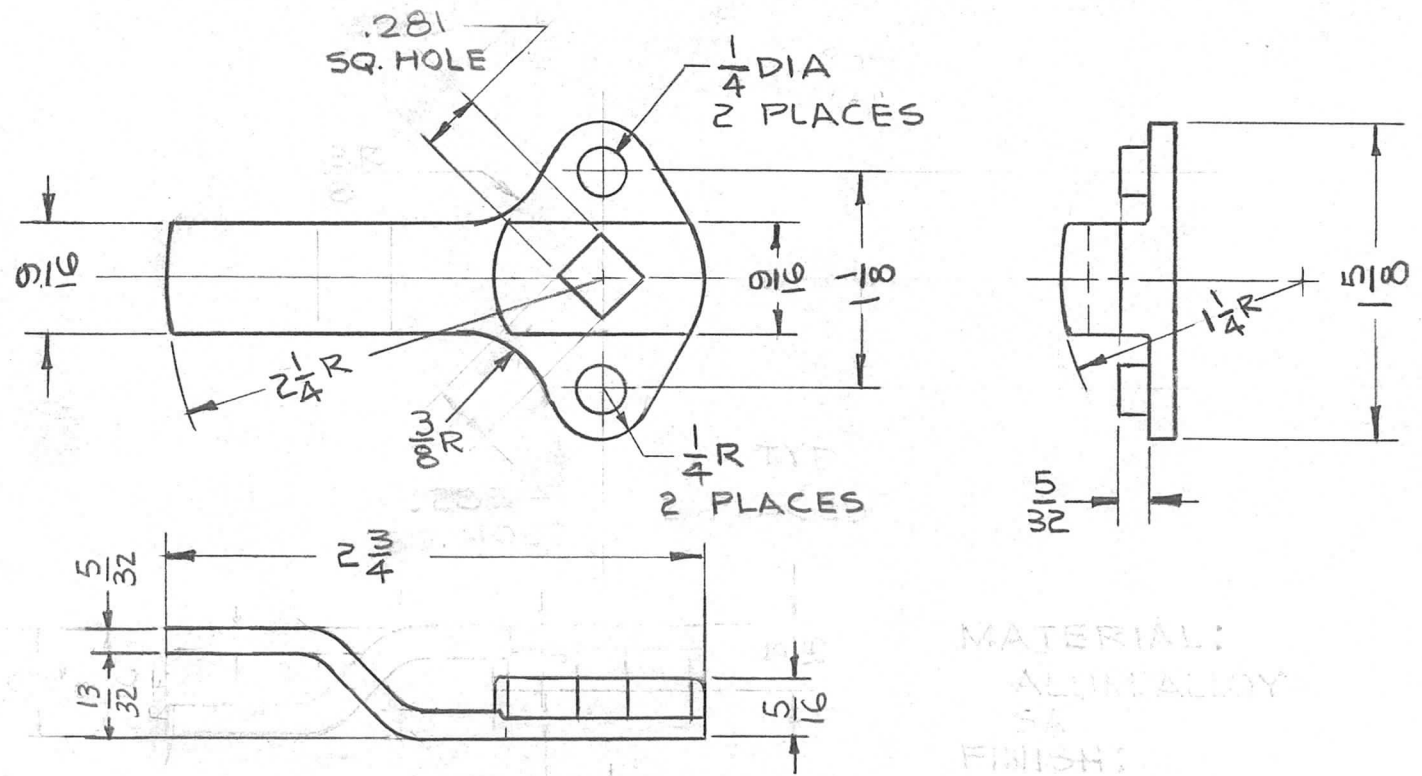

MATERIAL: ALUM. ALLOY
 FINISH: CASTING

							REQ. ITEM	PART NO.	KRUY	DESCRIPTION	SYMBOL							
							STOCK SIZE		THE TECHNICAL MATERIEL CORP. MAMARONECK, NEW YORK									
							BRONZE CASTING		CAM, LOCK									
							MATERIAL		BANOVIC <i>[Signature]</i> 9/30/65									
							TYPE & TEMPER		HEAT TREAT. SPEC.		DRAWN		CHECKED		FINAL APPROVAL			
							CADMIUM PLATE				<i>[Signature]</i>		10/5/65		PO 260			
							FINISH & SPEC. NO.		ELEC. DES. APP.		MECH. DES. APP.		Ø					
UNLESS OTHERWISE SPECIFIED DIMENSIONS ARE IN INCHES AND INCLUDE CHEMICALLY APPLIED OR PLATED FINISHES							SCALE 1:1											
DECIMALS .X ± .05 .XX ± .01 .XXX ± .005							FRACTIONS ± 1/64 ANGLES ± 0° 30'							CODE C 5401-189 (CORBIN 02505 1/2)				
ORIGINAL RELEASE							10/5/65					Ø						
SYM DESCRIPTION							DATE CH. NO. DRAFTS CHECKER ENG. APP.											