

IF IT IS FOUND DESIRABLE TO CHANGE ANY TOLERANCE OR OTHER DETAIL SPECIFIED ON THIS DRAWING NOTIFY THE PURCHASER PROMPTLY.

PM-350

MAXIMUM ALLOWABLE TOLERANCES HAVE BEEN DETERMINED AND DEVIATIONS WILL BE CAUSE FOR REJECTION. REMOVE ALL BURRS AND SHARP EDGES

REQ. PER UNIT	USED ON			
	MODEL	PROJECT NO.	ASS'Y. NO.	DATE
6	FSS			6-15-55

DRILL & TAP  
6-32

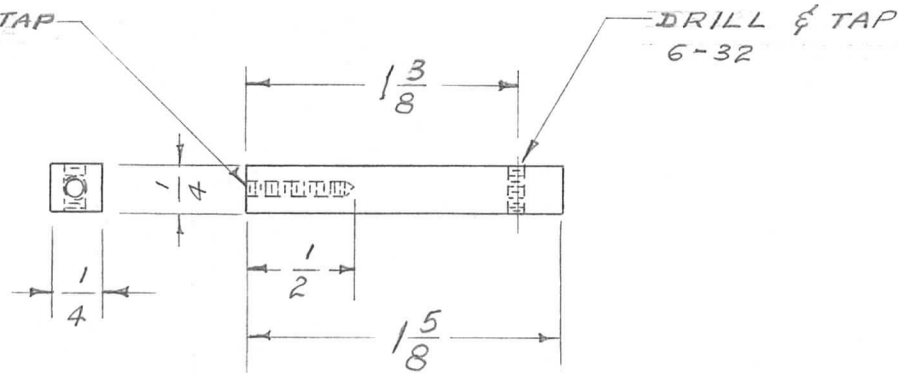

REQ.	ITEM	PART NO.	DESCRIPTION	SYMBOL
		$1\frac{5}{8} \times \frac{1}{4} \times \frac{1}{4}$	THE TECHNICAL MATERIEL CORP.	
		STOCK SIZE	MAMARONECK, NEW YORK	
	ALUMINUM	—#—	TERMINAL BOARD SUPPORT	
	MATERIAL	WEIGHT PER PC.		
		63S-75		
		TYPE & TEMPER	P.B. 6-15-55 2B	WAY
			DRAWN	ELEC. DES. APP.
			7-18-55	K2 A.J.J.
		HEAT TREAT. SPEC.	CHECKED	FINAL APPROVAL
		S-101 CAUSTIC DIP		PM-350
		FINISH & SPEC. NO.		

ISSUE	ITEM	CHANGED FROM	DATE	CN. NO.	DRAFTS	CHECKER	ENG. APP.
		TOLERANCES					
		SCALE					
ALL OTHERS		DEC. DIM. $\pm$ FRAC. DIM. $\pm$ Y6A ANGULAR DIM. $\pm$					
		DRILL, PUNCH, COMMERCIAL STOCK SIZES AND MANUFACTURERS TOLERANCES ARE NOT INCLUDED.					