

APPLICATION

REVISIONS

QTY	MODEL USED ON	ASS'Y NO.	LTR	DESCRIPTION	DATE	E.M.N.NO	DRAFT	CHKD	APPD
1	HFRR-4		X	EXP. RELEASE	11/17/67		JL		
			Ø	ORIG. RELEASE FOR PROD.	11-6-68	Ø	R.G.		

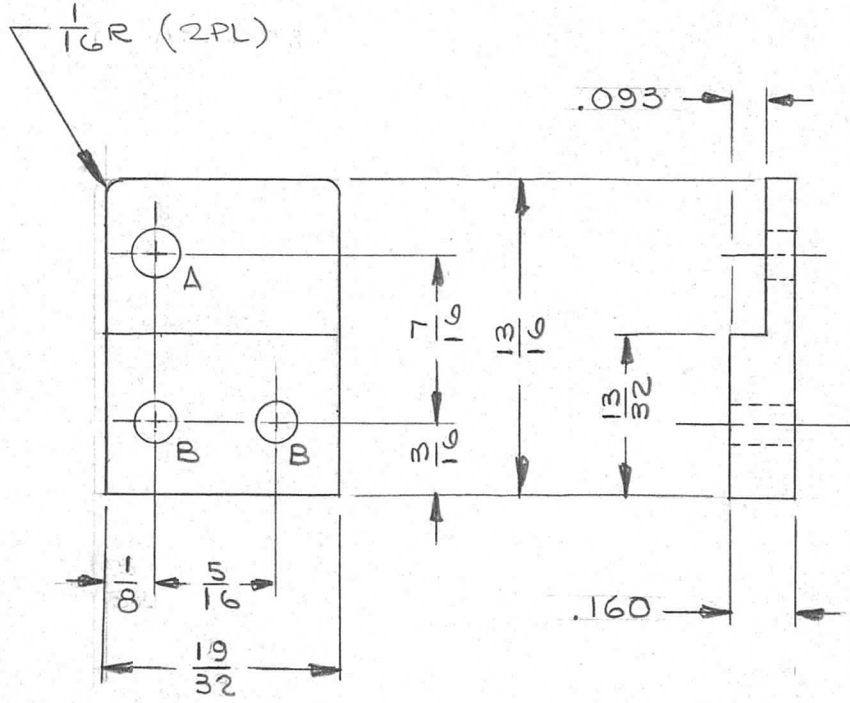

HOLE LEGEND		
HOLE	DESCRIPTION	REQ
A	.171 DIA	1
B	.125 DIA	2

UNLESS OTHERWISE SPECIFIED DIMENSIONS ARE IN INCHES AND INCLUDE CHEMICALLY APPLIED OR PLATED FINISHES DECIMALS FRACTIONS .X ± .05 TOLS. 1/64 .XX ± .01 ANGLES 0° - 30' .XXX ± .005	REQ'D	ITEM	PART NUMBER	DESCRIPTION	SYM.
			HOGAN(ZETENA)	LIST OF MATERIAL	SK 3252-003 - 34
	FINAL APPROVAL	DATE	THE TECHNICAL MATERIEL CORP.		
	MECH. DES. M. ZETENA	DATE	MAMARONECK, NEW YORK		
	ELECT. DES.	DATE	SHAFT SUPPORT-REAR (TUNER)		
MATERIAL .160 THICK ALUMINUM 2024-T3	CHECKED	DATE			
FINISH S404 YEL IRIDITE	DRAWN	DATE			
S401-451					

NOTICE TO PERSONS RECEIVING THIS DRAWING THE TECHNICAL MATERIEL CORPORATION claims proprietary right in the material disclosed hereon. This drawing is issued in confidence for engineering information only and may not be reproduced or used to manufacture anything shown hereon without permission from THE TECHNICAL MATERIEL CORPORATION to the user. This drawing is loaned for mutual assistance and is subject to recall at any time.	SIZE	CODE IDENT. NO.	DWG NO.	ISSUE
	A	82679	PM1358	Ø
SCALE	SHEET		OF	