

REQ. PER UNIT	USED ON			PM1095 $\emptyset$
	MODEL	ASS'Y. NO.	DATE	
	VLRB-1		7/2/64	

TMC PART#	"A"-DIM	REQ'D
PM1095-1	1.062	2
PM1095-2	1.093	2

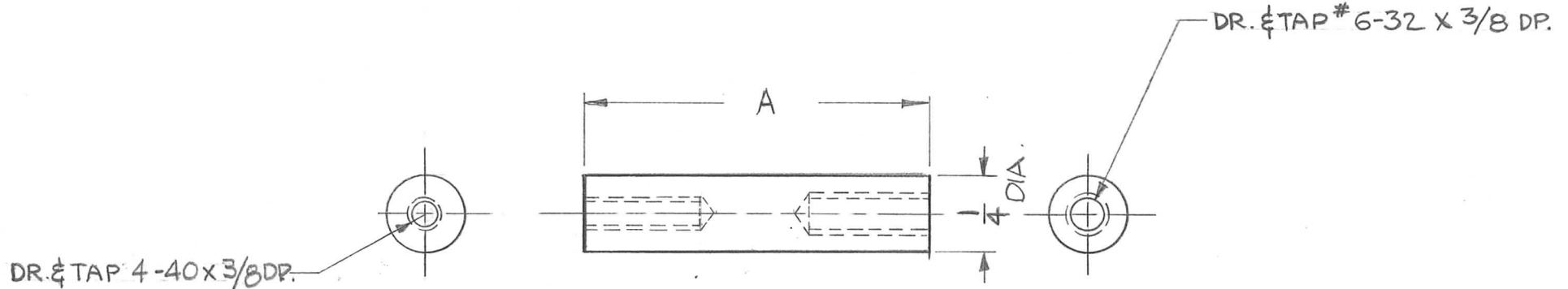

SYM	DESCRIPTION	DATE	CH. NO.	DRAFTS	CHECKER	ENG. APP.	REQ. ITEM	PART NO.	T. KRUY	DESCRIPTION	POSE	SYMBOL	
$\emptyset$	ORIGINAL RELEASE FOR PRODUCTION	9/1/65	$\emptyset$	Z.V.			AS NOTED			THE TECHNICAL MATERIEL CORP. MAMARONECK, NEW YORK			
X1	FINISH WAS SAO1 PASSIVATE (ERROR)	9/14/65	AA	JC			STAINLESS STEEL				SPACER		
X	EXPER. RELEASE	7/2/64		WB									
	UNLESS OTHERWISE SPECIFIED DIMENSIONS ARE IN INCHES AND INCLUDE CHEMICALLY APPLIED OR PLATED FINISHES	SCALE					# 303		WB 7.2.64				
		2:1					TYPE & TEMPER	HEAT TREAT. SPEC.	DRAWN	CHECKED	FINAL APPROVAL		
	DECIMALS .X $\pm$ .05 .XX $\pm$ .01 .XXX $\pm$ .005	FRACTIONS $\pm$ 1/64 ANGLES $\pm$ 0° 30'	TOLERANCES	CODE					S104 PASSIVATE				
			A					FINISH & SPEC. NO.	ELEC. DES. APP.	MECH. DES. APP.	PM1095 $\emptyset$		