

PRELIMINARY DRAWING

REQ. PER UNIT	USED ON		
	MODEL	ASS'Y. NO.	DATE
1	HFR-2	A3548	3-2-64
1	HFR-2	A3533	

PM-1037 A

Not For Production

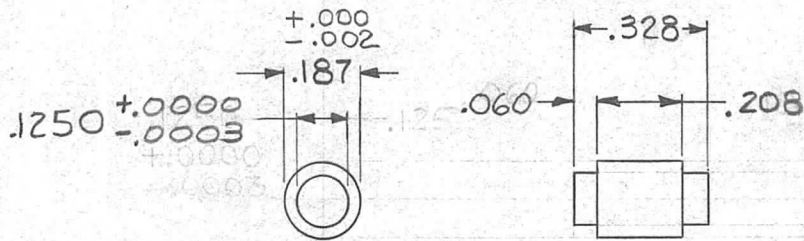

PIN

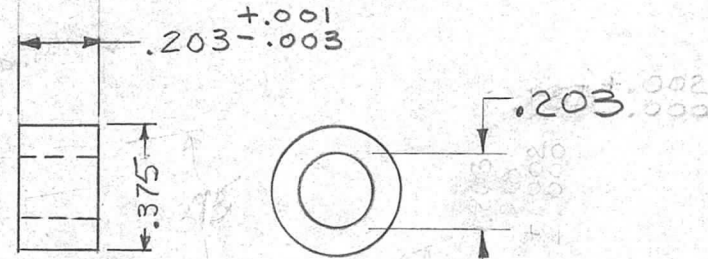

ROLLER

*See Drawing Requirements  
refer to Part 43*

NOTE:

REMOVE ALL BURRS & SHARP EDGES

REQ. ITEM	PART NO.	T. KRUY	DESCRIPTION	SYMBOL										
A	.203 WAS .187	6/8/65	14185	JCS										
Ø	ORIGINAL RELEASE FOR PRODUCTION	8-14-64	#	Sch										
X	EXP. RELEASE	3/2/64	#	SLD @										
SYM	DESCRIPTION	DATE	CH. NO.	DRAFTS	CHECKER	ENG. APP.	MATERIAL	STAINLESS STEEL	SPACER, DETENT ARM					
UNLESS OTHERWISE SPECIFIED DIMENSIONS ARE IN INCHES AND INCLUDE CHEMICALLY APPLIED OR PLATED FINISHES							SCALE	# 303	— # —	Drawn @ 5-5-64	Checked	Final Approval		
DECIMALS .X ± .05 .XX ± .01 .XXX ± .005							FRACTIONS ± 1/64 ANGLES ± 0° 30'	CODE	S104 PASSIVATE	TYPE & TEMPER	HEAT TREAT. SPEC.	DRAWN	CHECKED	FINAL APPROVAL
TOLERANCES							A	FINISH & SPEC. NO.		ELEC. DES. APP.	MECH. DES. APP.	PM 1037	A	