

REQ. PER UNIT	USED ON			PM-1030	A
	MODEL	ASS'Y. NO.	DATE		
1	HFR-2		2-11-64		
1	HFRR-2		9-11-64		

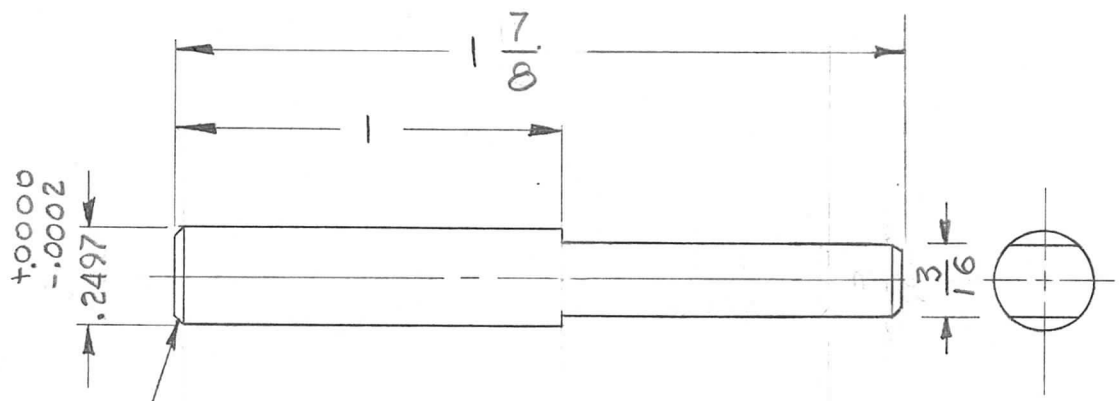

1/64 X 45° CHAMFER  
(BOTH ENDS)

NOTE:  
REMOVE ALL BURRS & SHARP EDGES

A	STAMP NOTE & P/N DELE	3.15.67	17957	LHD	<i>[Signature]</i>	<i>[Signature]</i>
Ø	ORIGINAL RELEASE FOR PRODUCTION	9-11-64	Ø	Ø.L.		
X3	TITLE WAS SHAFT	9-10-64		Ø.L.		
X2	DIM. .2497 WAS .250	8-4-64		G.D.L.		
X1	DIM 1 7/8 WAS 1 1/16	7-28-64		G.D.L.		
X	EXP. RELEASE	2-11-64				
SYM	DESCRIPTION	DATE	CH. NO.	DRAFTS	CHECKER	ENG. APP.
UNLESS OTHERWISE SPECIFIED DIMENSIONS ARE IN INCHES AND INCLUDE CHEMICALLY APPLIED OR PLATED FINISHES		SCALE 2:1				
DECIMALS .X ± .05 .XX ± .01 .XXX ± .005	TOLERANCES	FRACTIONS ± 1/64 ANGLES ± 0° 30'	CODE A			

REQ. ITEM	PART NO.	T. KRUY	DESCRIPTION	SYMBOL
	.250 ROD		THE TECHNICAL MATERIEL CORP. MAMARONECK, NEW YORK	
	STOCK SIZE		SHAFT, STRAIGHT	
	MATERIAL			
		<i>[Signature]</i>	<i>[Signature]</i>	<i>[Signature]</i>
TYPE & TEMPER	HEAT TREAT. SPEC.	DRAWN	CHECKED	FINAL APPROVAL
S104 PASSIVATE		<i>[Signature]</i>	<i>[Signature]</i>	PM-1030 A
FINISH & SPEC. NO.		ELEC. DES. APP.	MECH. DES. APP.	