

PL-182

SPECIFICATIONS

SERIES ~ QDL
 NO. OF CONTACTS ~ ONE (1)
 TYPE OF CONTACT ~ ROUND, MALE
 DIELECTRIC ~ TEFLON

ELECTRICAL DATA

MAX. PEAK VOLT. ~
 NOM. IMPEDANCE ~ 50Ω

CABLE ACCOMODATIONS

TYPE ~ STYROFLEX
 MAX. O.D. ~ 1 1/8
 IMPEDANCE ~ 50Ω

MATERIAL

EXT. PARTS ~ BRASS
 CONTACT ~ BERYLLIUM COPPER
 INSULATION ~ LOW LOSS PLASTIC
 DIELECTRIC (TEFLON)
 CLAMP ~ STAINLESS STEEL

FINISH

EXT. PARTS ~ SILVER PLATE w/RHODIUM FLASH
 CONTACT ~ SILVER PLATE w/GOLD FLASH

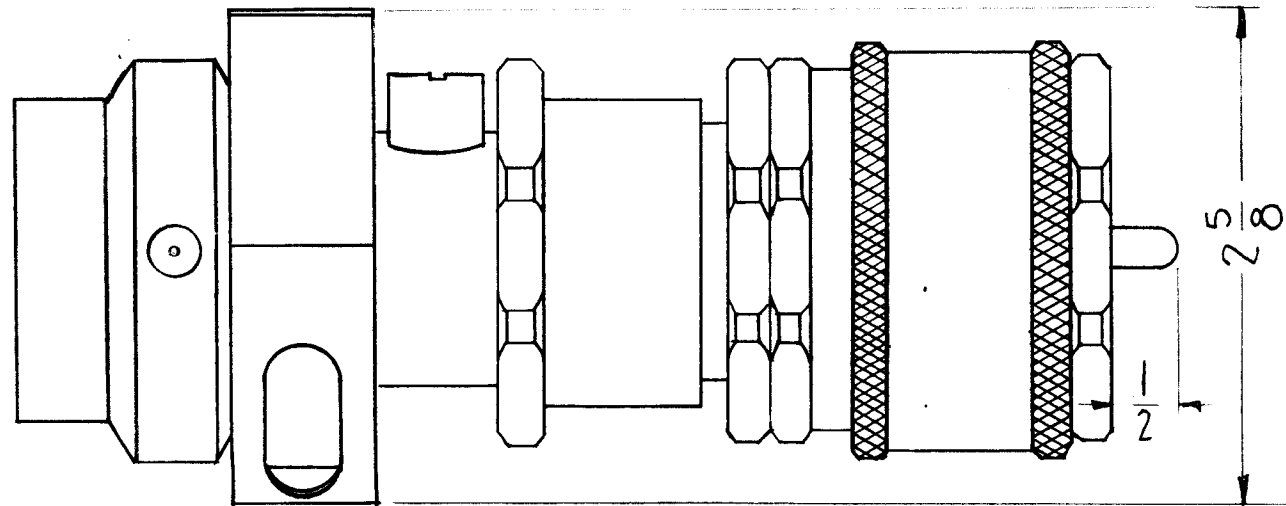

NOTE TO DRAWING ENGINEER: SEE SPEC. 401-70

THE TECHNICAL MATERIAL CORPORATION claims proprietary right in the model depicted herein. This drawing is issued in confidence for engineering information only and may not be reproduced or used to manufacture anything even in small quantities without permission from THE TECHNICAL MATERIAL CORPORATION to the user. This drawing is issued for technical assistance and is subject to recall at any time.

Property of:
 THE TECHNICAL MATERIAL CORPORATION
 MAMARONECK, NEW YORK

SYM	DESCRIPTION	DATE	CH. NO.	DRAFTS	CHECKER	ENG. APP.
UNLESS OTHERWISE SPECIFIED:		SCALE: 5-401-70(9204)				
DIMENSIONS ARE IN INCHES		MAXIMUM ALLOWABLE TOLERANCES HAVE BEEN DETERMINED AND ANY DEVIATIONS WILL BE CAUSE FOR REJECTION.				
TOLERANCES ON FRACTIONS ± 1/64 DECIMALS ± .005 ANGLES ± 1/2°		REMOVE ALL BURRS AND SHARP EDGES				

REQ. PER UNIT	MODEL	SECTION	ASS'Y. NO.	DATE
				5-22-61
USED ON				

REQ. ITEM	PART NO.	DESCRIPTION	SYMBOL										
		THE TECHNICAL MATERIAL CORP. MAMARONECK, NEW YORK											
		CONNECTOR, ADAPTER 1 1/8" 50Ω											
		STYROFLEX TO QDL PLUG											
		<table border="1"> <tr> <td>TYPE & TEMPER</td> <td>HEAT TREAT. SPEC.</td> <td>DRAWN</td> <td>CHECKER</td> <td>FINAL APPROVAL</td> </tr> <tr> <td></td> <td></td> <td><i>D. Mann</i></td> <td><i>H. Q.</i></td> <td><i>P. M.</i></td> </tr> </table>	TYPE & TEMPER	HEAT TREAT. SPEC.	DRAWN	CHECKER	FINAL APPROVAL			<i>D. Mann</i>	<i>H. Q.</i>	<i>P. M.</i>	
TYPE & TEMPER	HEAT TREAT. SPEC.	DRAWN	CHECKER	FINAL APPROVAL									
		<i>D. Mann</i>	<i>H. Q.</i>	<i>P. M.</i>									
		FINISH & SPEC. NO.	ELEC. DES. APP. MECH. DES. APP.	PL-182									