

TMC PART NO	CAT. NO	INSULATOR	DIMENSION		FOR USE WITH CABLE RG-10#	REMARKS	USED ON			
			L	H			REQ. PER UNIT	MODEL	ASS'Y. NO.	DATE
PL-168-1	45000	NYLON	3/4	.203	58	SOLDERLESS CONTACT				PL-168
-2	45025	NYLON	27/32	.258	59, 62	"				
-3	45050	"	3/4	.203	58, A, B, C	SOLDER TYPE CONTACT				
-4	45075	"	3/4	.177	.122					
-5	45100	"	3/4	.082	.070 TO .080	JACKET CLAMP				
-6	45125	"	3/4	.203	.120	"				
-7	45175	"	3/4	.094	.090	"				
-8	45275	KEL-F	3/4	.129	.120	"				
-9	45325	"	13/16	.194	.141					
-10	45425	"	3/4	.094	.090	JACKET CLAMP				
-11	45475	"	25/32	.082	.070 TO .080	"				
-12	45525	"	3/4	.203	58, A, B, C					
-13	45550	NYLON	27/32	.258	59, 62	SOLDER TYPE CONTACT				
-14	45600	KEL-F	3/4	.177	.122					
-15	45650	NYLON	3/4	.105	.174	JACKET CLAMP				
PL-168-16	45700	KEL-F	3/4	.144	.140					

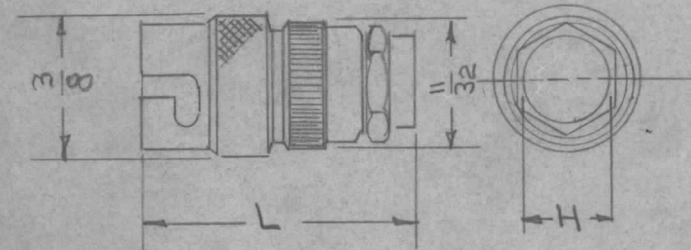

REQ.	ITEM	PART NO.	DESCRIPTION				SYMBOL
			THE TECHNICAL MATERIEL CORP. MAMARONECK, NEW YORK				
			STOCK SIZE				
			MATERIAL				
			PLUG, CONNECTOR				
ISSUE	ITEM	CHANGED FROM	DATE	CH. NO.	DRAFTS	CHECKER	ENG. APP.
TOLERANCES			SCALE: S-401-24				
DEC. DIM. ±			MAXIMUM ALLOWABLE TOLERANCES HAVE BEEN DETERMINED AND ANY DEVIATIONS WILL BE CAUSE FOR REJECTION. REMOVE ALL BURRS AND SHARP EDGES				
FRAC. DIM. ±							
ANGULAR DIM. ±							
TYPE & TEMPER		HEATTREAT. SPEC.	DRAWN	CHECKED	FINAL APPROVAL		
FINISH & SPEC. NO.		ELEC. DES. APP	MECH. DES. APP				
					PL-168		