

APPLICATION

QTY MODEL USED ON ASS'Y NO.

2 A5611

LTR

X  
Ø

DESCRIPTION

EXP. RELEASE  
ORIG. RELEASE FOR PROD

DATE

3/13/75

DRAFT

A.

APPD

REVISIONS

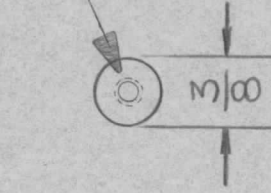

#6 COUNTERSINK  
.144 DIA. HOLE  
82° C'SNK TO .284  
DIA.

MUST HAVE  
ROUNDED  
EDGES.



SIDE  
VIEW

MSG574-1 (USED ON A5612)

QTY  
1

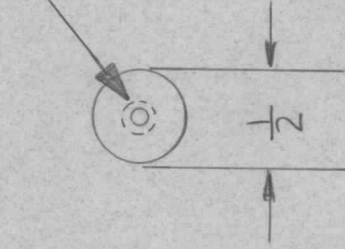

#6 COUNTERSINK  
.144 DIA. HOLE  
82° C'SNK TO  
.284 DIA.

MUST HAVE  
ROUNDED  
EDGES.



SIDE  
VIEW

MSG574-2 (USED ON A5611)

UNLESS OTHERWISE SPECIFIED  
DIMENSIONS ARE IN INCHES  
AND INCLUDE CHEMICALLY APPLIED  
OR PLATED FINISHES

DECIMALS FRACTIONS  
.X ± .05 TOLS. 1/64  
.XX ± .01 ANGLES 0°-30'  
.XXX ± .005

MATERIAL  
1/16 BRASS  
FINISH

REQ'D	ITEM	PART NUMBER	DESCRIPTION	SYM.
LIST OF MATERIAL				
FINAL APPROVAL	DATE	THE TECHNICAL MATERIEL CORP.		
MECH. DES.	DATE	MAMARONECK, NEW YORK		
ELECT. DES.	DATE	PLATE COIL AND CAPACITOR		
CHECKED	DATE	PLATES (OUTPUT COUPLER)		
DRAWN	DATE	SIZE	CODE IDENT. NO.	DWG NO.
F. JANNUZZI	12-14-74	A	82679	MSG 6574 -
F. JANNUZZI	1/19/74	SCALE		SHEET OF
				ISSUE
				Ø

NOTICE TO PERSONS RECEIVING THIS DRAWING  
THE TECHNICAL MATERIEL CORPORATION claims proprietary right in the material disclosed hereon. This drawing is issued in confidence for engineering information only and may not be reproduced or used to manufacture anything shown hereon without permission from THE TECHNICAL MATERIEL CORPORATION to the user. This drawing is loaned for mutual assistance and is subject to recall at any time.