

REQ. PER UNIT	USED ON			MS-2478	A
	MODEL	ASS'Y. NO.	DATE		
2	GPT-40K	AX-275	11-14-60		

HOLES  
A - 5/16 DIA.      REQ. 2

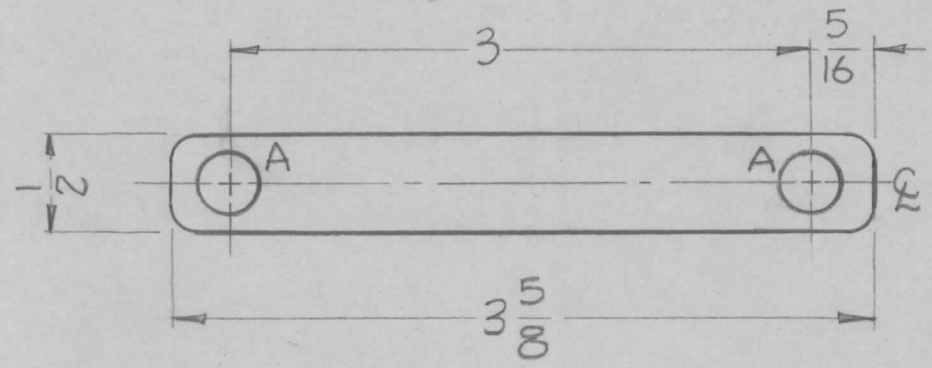

FINISH  
S 245 SILVER PLATE, .0003 THK  
S 423 SILVER KOTE IRIDITE,

UNLESS OTHERWISE SPECIFIED  
DIMENSIONS ARE IN INCHES AND INCLUDE  
CHEMICALLY APPLIED OR PLATED FINISHES

DECIMALS	FRACTIONS
.X ± .05	± 1/64
.XX ± .01	ANGLES
.XXX ± .005	± 0° 30'

TOLERANCES

CUT HERE  
GUARANTEED  
2-66

REQ.	ITEM	PART NO.	DESCRIPTION				SYMBOL
		.064 THK.	THE TECHNICAL MATERIEL CORP.				
		STOCK SIZE	MAMARONECK, NEW YORK				
		COPPER	STRAP, SWITCHING				
		MATERIAL					
A	1	FINISH WAS GOLD PL. .000025	8-23-62	7101	SG	<i>Jde</i>	<i>AB</i>
ISSUE	ITEM	CHANGED FROM	DATE	CH. NO.	DRAFTS	CHECKER	ENG. APP.
TOLERANCES			SCALE:				
DEC. DIM. ±			MAXIMUM ALLOWABLE TOLERANCES HAVE BEEN DETERMINED AND ANY DEVIATIONS WILL BE CAUSE FOR REJECTION.				
FRAC. DIM. ±			REMOVE ALL BURRS AND SHARP EDGES				
ANGULAR DIM. ±			TYPE & TEMPER		HEAT TREAT. SPEC.	DRAWN	CHECKED
			SEE NOTE				
			FINISH & SPEC. NO.		ELEC. DES. APP	MECH. DES. APP	MS-2478 A