

A ~ .191 DIA. HOLES 3 REQ.
(FOR NT-129-632-4)

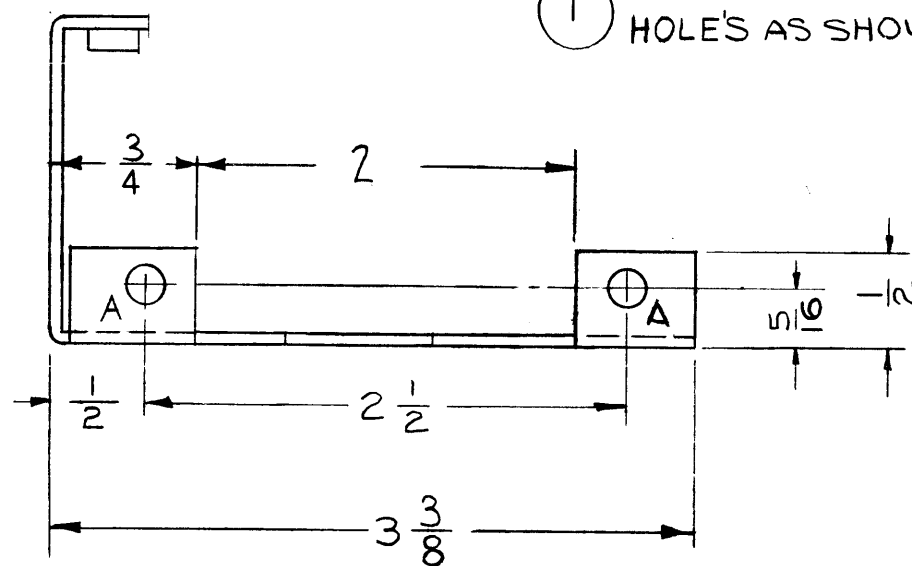

NOTICE TO PERSONS RECEIVING THIS DRAWING
THE TECHNICAL MATERIEL CORPORATION claims proprietary right in the material disclosed hereon. This drawing is issued in confidence for engineering information only and may not be reproduced or used to manufacture anything shown hereon without permission from THE TECHNICAL MATERIEL CORPORATION to the user. This drawing is loaned for mutual assistance and is subject to recall at any time.

Property of:
THE TECHNICAL MATERIEL CORPORATION
MAMARONECK, NEW YORK

C	2	1/8" NOTCH ADDED (TOP VIEW)	2-28-61	4291	RU	JCS	JCS
	1	DIM 2 WDS 1 3/4 (BOTTOM VIEW)					
B	2	1 3/4 NOTCH ADDED	1-4-61	3854	M.A.F.	JCS	JCS
	1	ONE "A" HOLE DELETED					
A	3	3/8 R. WAS 3/4 D. IN ERROR	12-20-60	3745	M.A.F.	JCS	JCS
	2	O/A DIM. 3 3/8 WAS 3 1/2					
	1	LIP DELETED					

ISSUE	ITEM	CHANGED FROM	DATE	CH. NO.	DRAFTS	CHECKER	ENG. APP.
TOLERANCES			SCALE: FULL				
DEC. DIM. ±			MAXIMUM ALLOWABLE TOLERANCES HAVE BEEN DETERMINED AND ANY DEVIATIONS WILL BE CAUSE FOR REJECTION.				
FRAC. DIM. ± 1/64			REMOVE ALL BURRS AND SHARP EDGES				
ANGULAR DIM. ±							

1	CHG-1			9-28-60
REQ. PER UNIT	MODEL	PROJECT NO.	ASS'Y. NO.	DATE
USED ON				

3	1	NT-129-632-4	NUT ROUND SWAGE TYPE	
REQ. ITEM	PART NO.		DESCRIPTION	
	.064		THE TECHNICAL MATERIEL CORP. MAMARONECK, NEW YORK	
STOCK SIZE			REAR SHIELD, BOTTOM	
MATERIAL				
5052-H32			AS	JCS
TYPE & TEMPER		HEAT TREAT. SPEC.	DRAWN	CHECKED
S-404 YELLOW IRDITE			JCS	JCS
FINISH & SPEC. NO.			ELEC. DES. APP.	MECH. DES. APP.
				MS-2419 C