

ISSUE	ITEM	CHANGED FROM	DATE	CN. NO.	DRAFTS	CHECKER	ENG. APP.	REQ.	ITEM	PART NO.	DESCRIPTION	SYMBOL
X		ENG. REL	NOV 3-69		DGW							

FINISH

- 5114 - ZINC CROMATE PRIMER.
- 5115 - SMOOTH GRAY ENAMEL.

OR

PRIME & PAINT PER  
CUSTOMER'S SPECIFICATIONS

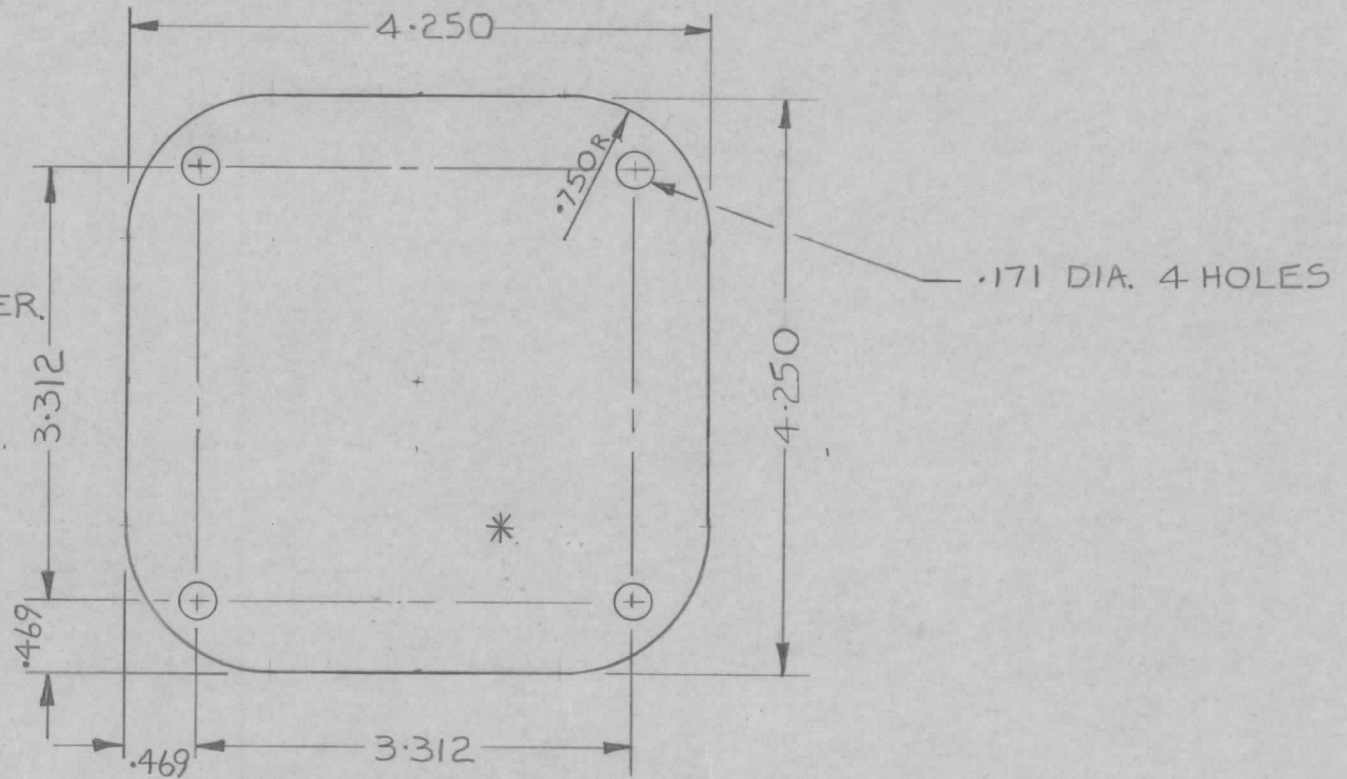

\* PERFORATED PLATE 1/16 HOLES

MCU-16	085/69		OCT 31/69	.051 THICK		TMC (Canada) LIMITED							
MODEL	PROJECT NO.	ASS'Y. NO.	DATE	STOCK SIZE		OTTAWA	ONTARIO						
USED ON				ALUM. ALLOY	LOUDSPEAKER SCREEN								
MAXIMUM ALLOWABLE TOLERANCES HAVE BEEN DETERMINED AND DEVIATIONS WILL BE CAUSE FOR REJECTION. REMOVE ALL BURRS AND SHARP EDGES.				IF IT IS FOUND DESIRABLE TO CHANGE ANY TOLERANCE OR OTHER DETAIL SPECIFIED ON THIS DRAWING NOTIFY THE PURCHASER PROMPTLY.				MATERIAL		WEIGHT PER PC.			
								57S H32					
TOLERANCES DEC. DIM. ± .X = .05 FRAC. DIM. ± 1/64 .XX = .01 ANGULAR DIM. ± 0° 30' .XXX = .005				SCALE NTS DIMENSIONS IN INCHES UNLESS OTHERWISE SPECIFIED DRILL PUNCH, COMMERCIAL STOCK SIZES AND MANUFACTURERS TOLERANCES ARE NOT INCLUDED.				TYPE & TEMPER		HEAT TREAT. SPEC.			
								DGW					
ALL OTHERS				YEL. IRIDITE S404				DRAWN		ELEC. DES. APP.		MECH. DES. APP.	
FINISH & SPEC. NO.				MS 11121				CHECKED		FINAL APPROVAL		X	



ISSUE	ITEM	CHANGED FROM	DATE	CN. NO.	DRAFTS	CHECKER	ENG. APP.	REQ.	ITEM	PART NO.	DESCRIPTION	SYMBOL
Ø		REL TO PROD	31 MAR 71			PA/FR.						

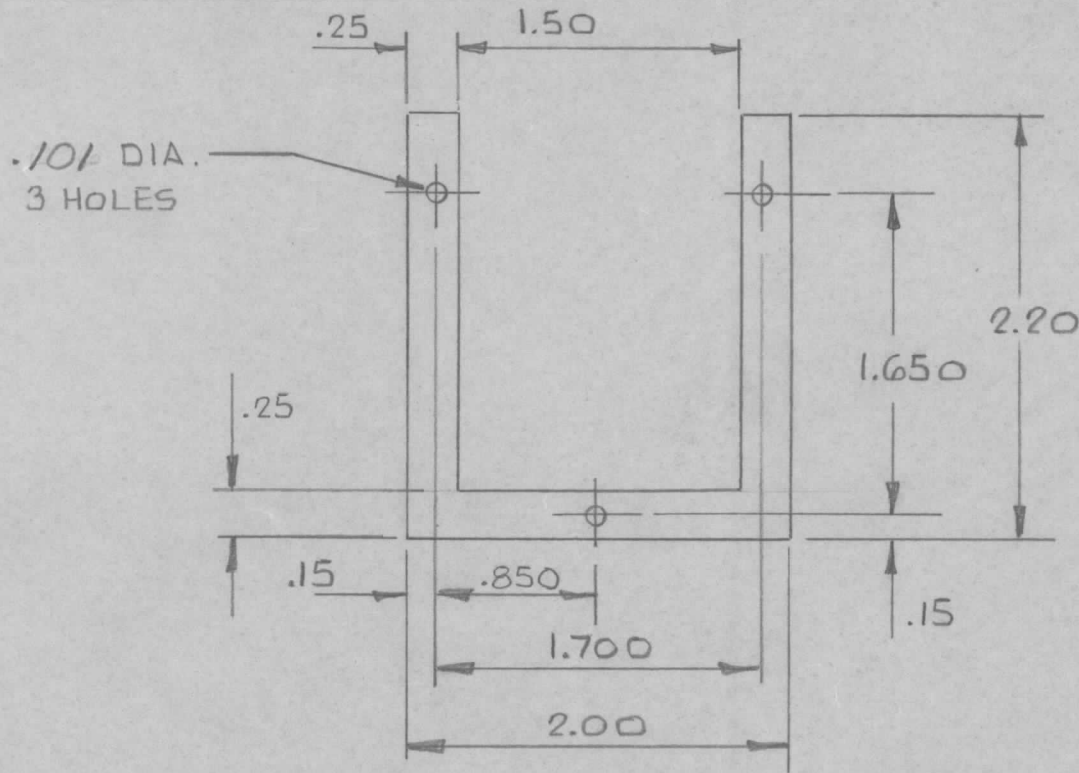

HF OVEN	086/69		18 DEC 69	.031		TMC (Canada) LIMITED OTTAWA ONTARIO					
MODEL	PROJECT NO.	ASS'Y. NO.	DATE	STOCK SIZE		SPACER, LABEL					
USED ON				ALUM ALLOY.	MATERIAL		H.F. OVEN				
MAXIMUM ALLOWABLE TOLERANCES HAVE BEEN DETERMINED AND DEVIATIONS WILL BE CAUSE FOR REJECTION. REMOVE ALL BURRS AND SHARP EDGES				IF IT IS FOUND DESIRABLE TO CHANGE ANY TOLERANCE OR OTHER DETAIL SPECIFIED ON THIS DRAWING NOTIFY THE PURCHASER PROMPTLY.				PROCTOR			
								TYPE & TEMPER		MECH. DES. APP.	
TOLERANCES				SCALE 1:1				DRAWN			
ALL OTHERS DEC. DIM. ± .X = .05 FRAC. DIM. ± 1/64 .XX = .01 ANGULAR DIM. ± 0° 30' .XXX = .005				DIMENSIONS IN INCHES UNLESS OTHERWISE SPECIFIED DRILL: PUNCH. COMMERCIAL STOCK SIZES AND MANUFACTURERS TOLERANCES ARE NOT INCLUDED.				ELEC. DES. APP.		MECH. DES. APP.	
								HEAT TREAT. SPEC.			
				GLOSS WHITE				MS 11139		Ø	
				FINISH & SPEC. NO.							

ISSUE	ITEM	CHANGED FROM	DATE	CN. NO.	DRAFTS	CHECKER	ENG. APP.	REQ.	ITEM	PART NO.	DESCRIPTION	SYMBOL
Ø		REL TO PROD	22 APR 70		P.S							
A		REV PER CEMJ	JULY 6/71	1032	NAT.							

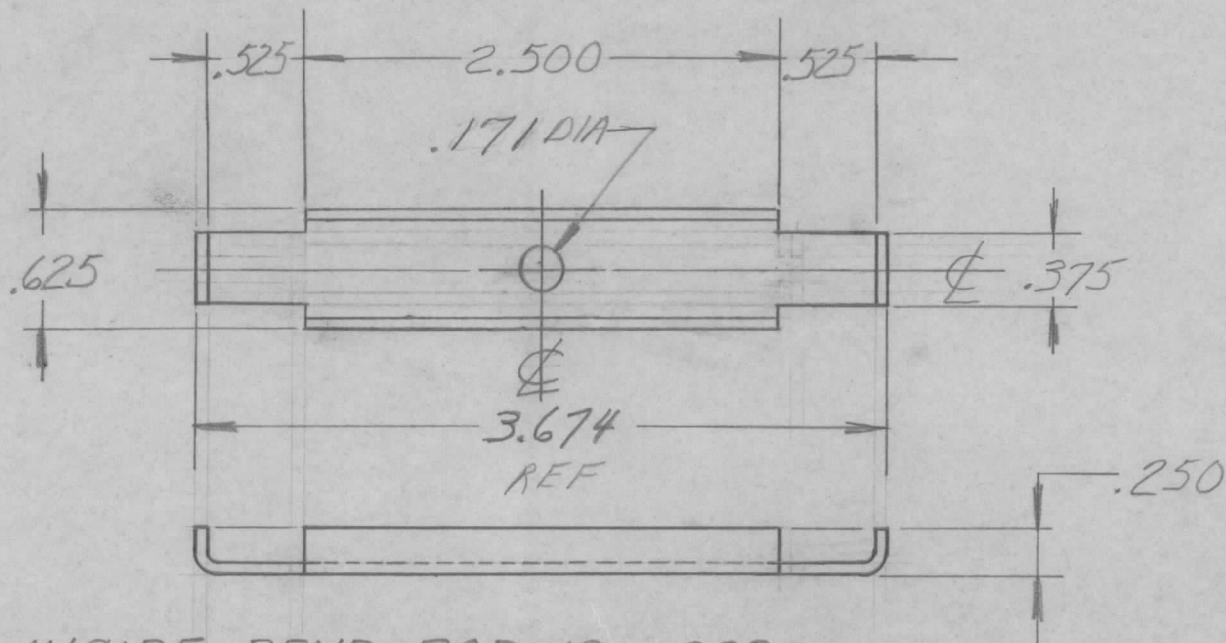

MINIMUM INSIDE BEND RADIUS, .062.

METAL STAMP TMC PART No., 1/8 HIGH, GOTHIC.

LPA		088-69		5 JAN 70		.062 THK		TMC (Canada) LIMITED OTTAWA ONTARIO			
MODEL		PROJECT NO.		ASS'Y. NO.		DATE		STOCK SIZE		BRKT, MOUNTING - C.B.	
USED ON				AL ALY		WEIGHT PER PC.		DRAWN: P. WILLIAMS			
MAXIMUM ALLOWABLE TOLERANCES HAVE BEEN DETERMINED AND DEVIATIONS WILL BE CAUSE FOR REJECTION. REMOVE ALL BURRS AND SHARP EDGES				IF IT IS FOUND DESIRABLE TO CHANGE ANY TOLERANCE OR OTHER DETAIL SPECIFIED ON THIS DRAWING NOTIFY THE PURCHASER PROMPTLY.				575 H32		ELEC. DES. APP.	
TOLERANCES				SCALE 1/1				TYPE & TEMPER		MECH. DES. APP.	
ALL OTHERS				DIMENSIONS IN INCHES UNLESS OTHERWISE SPECIFIED				HEAT TREAT. SPEC.		CHECKED	
DEC. DIM. ± .015 -X = -.05				DRILL: PUNCH. COMMERCIAL STOCK SIZES AND MANUFACTURERS TOLERANCES ARE NOT INCLUDED.				IRIDITE 5904		FINAL APPROVAL	
FRAC. DIM. ± 1/64 -XX = .01										MS11140	
ANGULAR DIM. ± 0° 30' -XXX = .005										A	



ISSUE	ITEM	CHANGED FROM	DATE	CN. NO.	DRAFTS	CHECKER	ENG. APP.	REQ.	ITEM	PART NO.	DESCRIPTION	SYMBOL
Ø		REL TO PROD	5 JAN 69		PW							

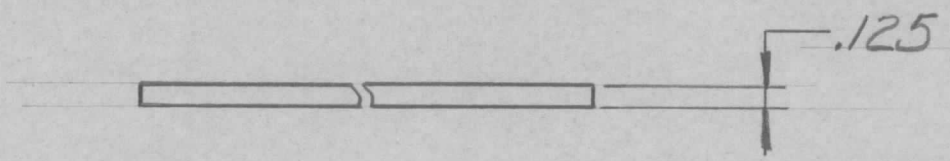

MS11142 - LENGTH IN INCHES

TMC DWG NO.

4.500

DATE 6 July, 71 MS11142 Ø

PART NO.	REV.

THIS DRAWING HAS BEEN YELLOW FLAGGED.  
CHANGES PROPOSED.

AFFECTS MANUFACTURE NAT.

DOES NOT AFFECT MANUFACTURE

---

**For Material Control use only**

STOP PROCUREMENT

CONTINUE PROCUREMENT

MS11142 Ø

<u>STANDARD</u>				
MODEL	PROJECT NO.	ASS'Y. NO.	DATE	.020
USED ON				
MAXIMUM ALLOWABLE TOLERANCES HAVE BEEN DETERMINED AND DEVIATIONS WILL BE CAUSE FOR REJECTION. REMOVE ALL BURRS AND SHARP EDGES		IF IT IS FOUND DESIRABLE TO CHANGE ANY TOLERANCE OR OTHER DETAIL SPECIFIED ON THIS DRAWING NOTIFY THE PURCHASER PROMPTLY.		
TOLERANCES		SCALE		
ALL OTHERS	DEC. DIM. <u>± 0.015</u> <del>± .05</del>	DIMENSIONS IN INCHES UNLESS OTHERWISE SPECIFIED		
	FRAC. DIM. <u>± 1/64</u> <del>± .01</del>	DRILL, PUNCH, COMMERCIAL STOCK SIZES AND MANUFACTURERS TOLERANCES ARE NOT INCLUDED.		
	ANGULAR DIM. <u>± 0° 30'</u> <del>± .005</del>	FINISH & SPEC. N		

ISSUE	ITEM	CHANGED FROM	DATE	CN. NO.	DRAFTS	CHECKER	ENG. APP.	REQ.	ITEM	PART NO.	DESCRIPTION	SYMBOL
-------	------	--------------	------	---------	--------	---------	-----------	------	------	----------	-------------	--------

X ENG REL 16 FEB 70 

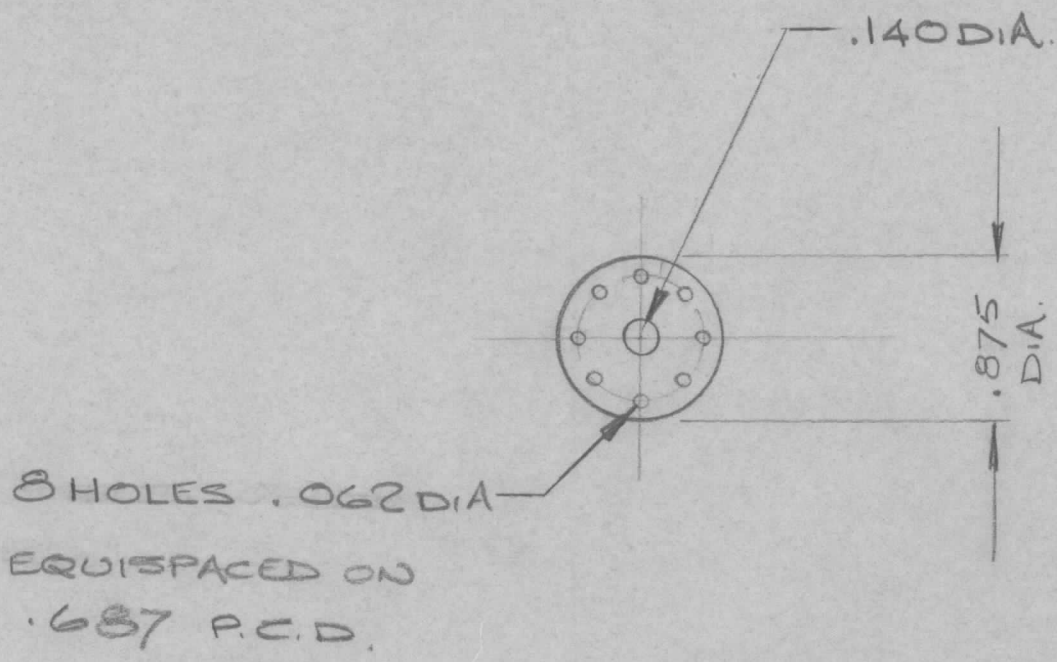

MEL		085/70		16 FEB 70		.024 THK		TMC (Canada) LIMITED					
MODEL		PROJECT NO.		ASS'Y. NO.		DATE		STOCK SIZE		OTTAWA ONTARIO			
USED ON						COPPER		TERMINAL SOLDER					
MAXIMUM ALLOWABLE TOLERANCES HAVE BEEN DETERMINED AND DEVIATIONS WILL BE CAUSE FOR REJECTION. REMOVE ALL BURRS AND SHARP EDGES						IF IT IS FOUND DESIRABLE TO CHANGE ANY TOLERANCE OR OTHER DETAIL SPECIFIED ON THIS DRAWING NOTIFY THE PURCHASER PROMPTLY.						SIMPSON	
												DRAWN	
TOLERANCES						SCALE		HEAT TREAT. SPEC.		CHECKED		FINAL APPROVAL	
ALL OTHERS		DEC. DIM. $\pm$ .05		.X = .05		DIMENSIONS IN INCHES UNLESS OTHERWISE SPECIFIED							
		FRAC. DIM. $\pm$ $\frac{1}{64}$		.XX = .01		DRILL: PUNCH, COMMERCIAL STOCK SIZES AND MANUFACTURERS TOLERANCES ARE NOT INCLUDED.							
		ANGULAR DIM. $\pm$ 0° 30'		.XXX = .005		TIN/LEAD SOLDER DIP		FINISH & SPEC. NO.		MS11167		X	

ISSUE	ITEM	CHANGED FROM	DATE	CN. NO.	DRAFTS	CHECKER	ENG. APP.	REQ.	ITEM	PART NO.	DESCRIPTION	SYMBOL
Ø		PROD RELEASE	7 APR 1970		SP							
A		REV PER CEMN	22 OCT 71	1078	BR	Hed	JW					

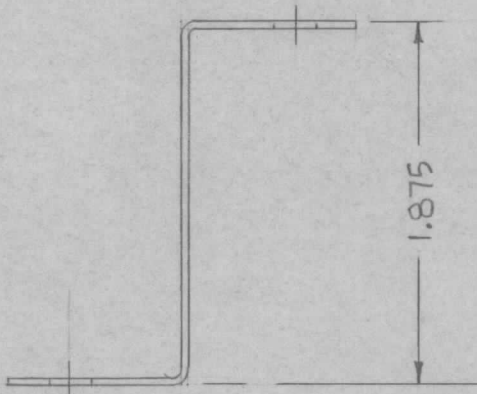
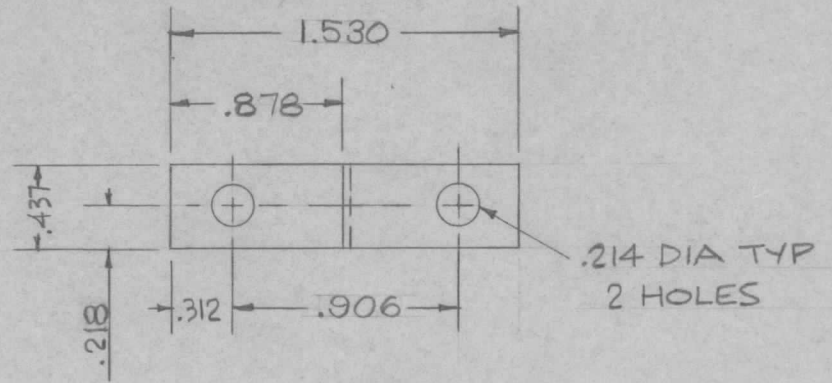

MIN. BENDING RADIUS: .024 INSIDE

LPA-1		088/70		26 MAR 1970		.025 THK		TMC (Canada) LIMITED	
MODEL		PROJECT NO.		ASS'Y. NO.		DATE		OTTAWA ONTARIO	
USED ON						COPPER		LEAD CONNECTING	
MAXIMUM ALLOWABLE TOLERANCES HAVE BEEN DETERMINED AND DEVIATIONS WILL BE CAUSE FOR REJECTION. REMOVE ALL BURRS AND SHARP EDGES				IF IT IS FOUND DESIRABLE TO CHANGE ANY TOLERANCE OR OTHER DETAIL SPECIFIED ON THIS DRAWING NOTIFY THE PURCHASER PROMPTLY.				M.H. Smart	
TOLERANCES				SCALE 1:1				DRAWN	
ALL OTHERS		DEC. DIM. $\pm 1.015$		.X = .05		HEAT TREAT. SPEC.		ELEC. DES. APP.	
		FRAC. DIM. $\pm \frac{1}{64}$		.XX = .01		SILVER PLATE S245.0003		MECH. DES. APP.	
		ANGULAR DIM. $\pm 0^{\circ} 30'$		.XXX = .005		FINISH & SPEC. NO.		FINAL APPROVAL	
								MS11194	
								A	



ISSUE	ITEM	CHANGED FROM	DATE	CN. NO.	DRAFTS	CHECKER	ENG. APP.	REQ.	ITEM	PART NO.	DESCRIPTION	SYMBOL
Ø		PROD RELEASE	7 APR 1960		AD							

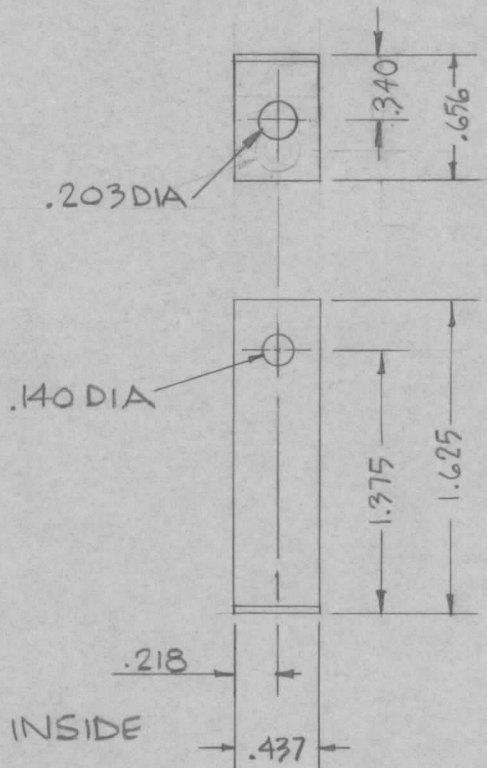

MIN. BENDING RADIUS: .024 INSIDE

LPA-1		088/70		26 MAR 1970		.025 THK		TMC (Canada) LIMITED OTTAWA ONTARIO			
MODEL		PROJECT NO.		ASS'Y. NO.		DATE		STOCK SIZE			
USED ON						COPPER		LEAD CONNECTING			
MAXIMUM ALLOWABLE TOLERANCES HAVE BEEN DETERMINED AND DEVIATIONS WILL BE CAUSE FOR REJECTION. REMOVE ALL BURRS AND SHARP EDGES						IF IT IS FOUND DESIRABLE TO CHANGE ANY TOLERANCE OR OTHER DETAIL SPECIFIED ON THIS DRAWING NOTIFY THE PURCHASER PROMPTLY.					
TOLERANCES						SCALE 1:1		MATERIAL		WEIGHT PER PC.	
ALL OTHERS						DEC. DIM. ± .015		TYPE & TEMPER		DRAWN	
						FRAC. DIM. ± 1/64		HEAT TREAT. SPEC.		ELEC. DES. APP.	
						ANGULAR DIM. ± 0° 30'		5245 SILVER PLATE		MECH. DES. APP.	
						.XX = -.01		.0003		CHECKED	
						.XXX = .005		FINISH & SPEC. NO.		FINAL APPROVAL	
										MS11195 Ø	



ISSUE	ITEM	CHANGED FROM	DATE	CN. NO.	DRAFTS	CHECKER	ENG. APP.	REQ.	ITEM	PART NO.	DESCRIPTION	SYMBOL
Ø		PROD RELEASE	7 APR 1970		AP							
A		REV PER CEMU	JULY 6/71	1032	MT							

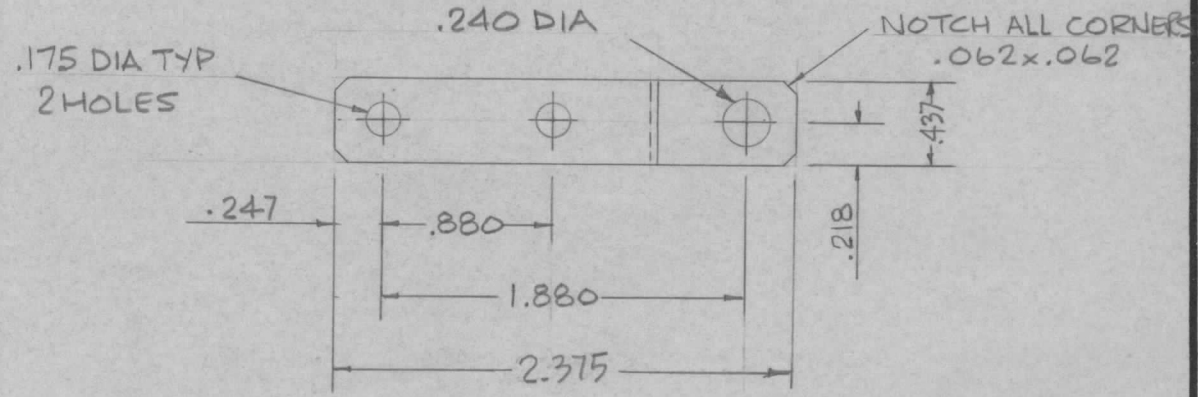
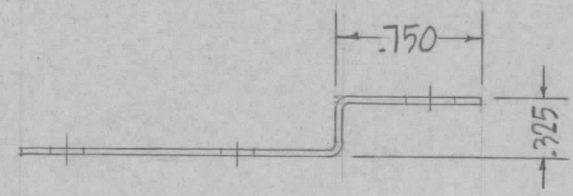

MINIMUM INSIDE BEND RADIUS .025"

LPA-1		088/70		26 MAR 1970		.025 THK		TMC (Canada) LIMITED OTTAWA ONTARIO			
MODEL		PROJECT NO.		ASS'Y. NO.		DATE		STOCK SIZE			
USED ON						COPPER		LEAD CONNECTING			
MAXIMUM ALLOWABLE TOLERANCES HAVE BEEN DETERMINED AND DEVIATIONS WILL BE CAUSE FOR REJECTION. REMOVE ALL BURRS AND SHARP EDGES						IF IT IS FOUND DESIRABLE TO CHANGE ANY TOLERANCE OR OTHER DETAIL SPECIFIED ON THIS DRAWING NOTIFY THE PURCHASER PROMPTLY.					
TOLERANCES						SCALE 1:1		MATERIAL		WEIGHT PER PC.	
ALL OTHERS						DEC. DIM. ±.015 .X=-.05		TYPE & TEMPER		DRAWN	
						FRAC. DIM. ± 1/64 .XX=-.01		HEAT TREAT. SPEC.		ELEC. DES. APP.	
						ANGULAR DIM. ± 0° 30' .XX-X=-.005		S245 SILVER PLATE .0003		MECH. DES. APP.	
						DIMENSIONS IN INCHES UNLESS OTHERWISE SPECIFIED		FINISH & SPEC. NO.		CHECKED	
						DRILL, PUNCH, COMMERCIAL STOCK SIZES AND MANUFACTURERS TOLERANCES ARE NOT INCLUDED.				FINAL APPROVAL	
										MS11196 A	

ISSUE	ITEM	CHANGED FROM	DATE	CN. NO.	DRAFTS	CHECKER	ENG. APP.	REQ.	ITEM	PART NO.	DESCRIPTION	SYMBOL
Ø		PROD RELEASE	7 APR 1970		<i>AS</i>		<i>[Signature]</i>					

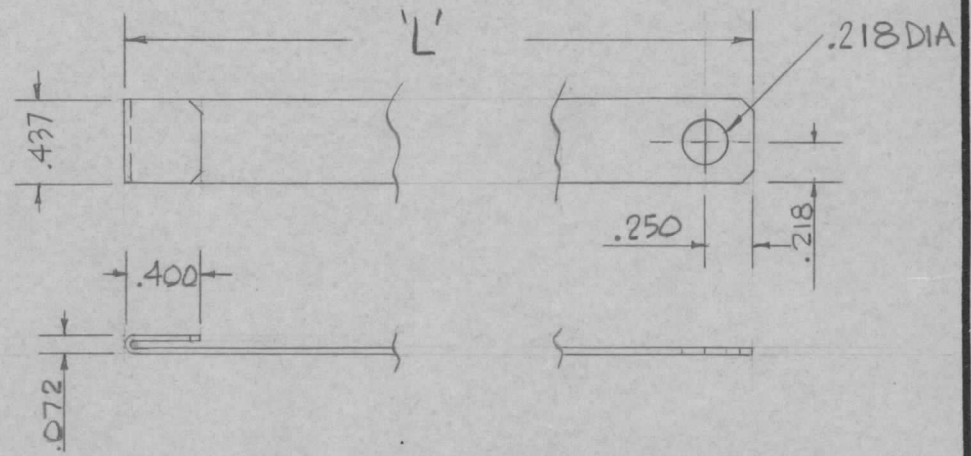

TMC PART N°	'L'
MS11197-1	7.250
MS11197-2	10.000

NOTCH ALL CORNERS .062 x .062

LPA-1	088-70		26 MAR 1970	.024 THK		TMC (Canada) LIMITED	
MODEL	PROJECT NO.	ASS'Y. NO.	DATE	STOCK SIZE		OTTAWA	ONTARIO
USED ON				COPPER		LEAD CONNECTING	
MAXIMUM ALLOWABLE TOLERANCES HAVE BEEN DETERMINED AND DEVIATIONS WILL BE CAUSE FOR REJECTION. REMOVE ALL BURRS AND SHARP EDGES.				IF IT IS FOUND DESIRABLE TO CHANGE ANY TOLERANCE OR OTHER DETAIL SPECIFIED ON THIS DRAWING NOTIFY THE PURCHASER PROMPTLY.			
				MATERIAL		WEIGHT PER PC.	
TOLERANCES DEC. DIM. $\pm .015$ *X = .05 FRAC. DIM. $\pm \frac{1}{64}$ **X = .01 ANGULAR DIM. $\pm 0^{\circ} 30'$ ***X = .008				SCALE 1:1		DRAWN <i>M. Smart</i>	
				TYPE & TEMPER		ELEC. DES. APP. <i>[Signature]</i>	
ALL OTHERS DIMENSIONS IN INCHES UNLESS OTHERWISE SPECIFIED DRILL, PUNCH, COMMERCIAL STOCK SIZES AND MANUFACTURERS TOLERANCES ARE NOT INCLUDED.				HEAT TREAT. SPEC.		CHECKED <i>R. Sutherland</i>	
				S245 SILVER PLATE .0003		FINAL APPROVAL	
				FINISH & SPEC. NO.		MS11197 Ø	