

ISSUE	ITEM	CHANGED FROM	DATE	CN. NO.	DRAFTS	CHECKER	ENG. APP.	REQ.	ITEM	PART NO.	DESCRIPTION	SYMBOL
Ø		PROD RELEASE	7 APR 1970		<i>AS</i>		<i>[Signature]</i>					

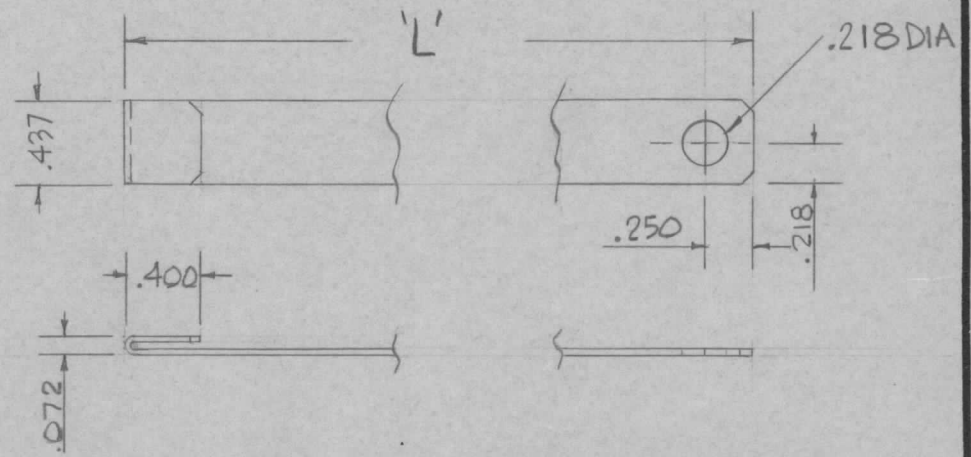

TMC PART N°	'L'
MS11197-1	7.250
MS11197-2	10.000

NOTCH ALL CORNERS .062 x .062

LPA-1	088-70		26 MAR 1970	.024 THK		TMC (Canada) LIMITED	
MODEL	PROJECT NO.	ASS'Y. NO.	DATE	STOCK SIZE		OTTAWA	ONTARIO
USED ON				COPPER		LEAD CONNECTING	
MAXIMUM ALLOWABLE TOLERANCES HAVE BEEN DETERMINED AND DEVIATIONS WILL BE CAUSE FOR REJECTION. REMOVE ALL BURRS AND SHARP EDGES.				IF IT IS FOUND DESIRABLE TO CHANGE ANY TOLERANCE OR OTHER DETAIL SPECIFIED ON THIS DRAWING NOTIFY THE PURCHASER PROMPTLY.			
				MATERIAL		WEIGHT PER PC.	
TOLERANCES DEC. DIM. $\pm .015$ *X = .05 FRAC. DIM. $\pm \frac{1}{64}$ **X = .01 ANGULAR DIM. $\pm 0^{\circ} 30'$ ***X = .008				SCALE 1:1		DRAWN <i>M. Smart</i>	
				TYPE & TEMPER		ELEC. DES. APP. <i>[Signature]</i>	
ALL OTHERS DIMENSIONS IN INCHES UNLESS OTHERWISE SPECIFIED DRILL, PUNCH, COMMERCIAL STOCK SIZES AND MANUFACTURERS TOLERANCES ARE NOT INCLUDED.				HEAT TREAT. SPEC.		CHECKED <i>R. Sutherland</i>	
				S245 SILVER PLATE .0003		FINAL APPROVAL	
				FINISH & SPEC. NO.		MS11197 Ø	