

4

3

2

1

REVISIONS						
ZONE	LTR	DESCRIPTION	DATE	E.M.N.NO	DRAFT	CHKD APPD
2C	A	REVISED WEIGHT	1/20/69	4	KRH	17

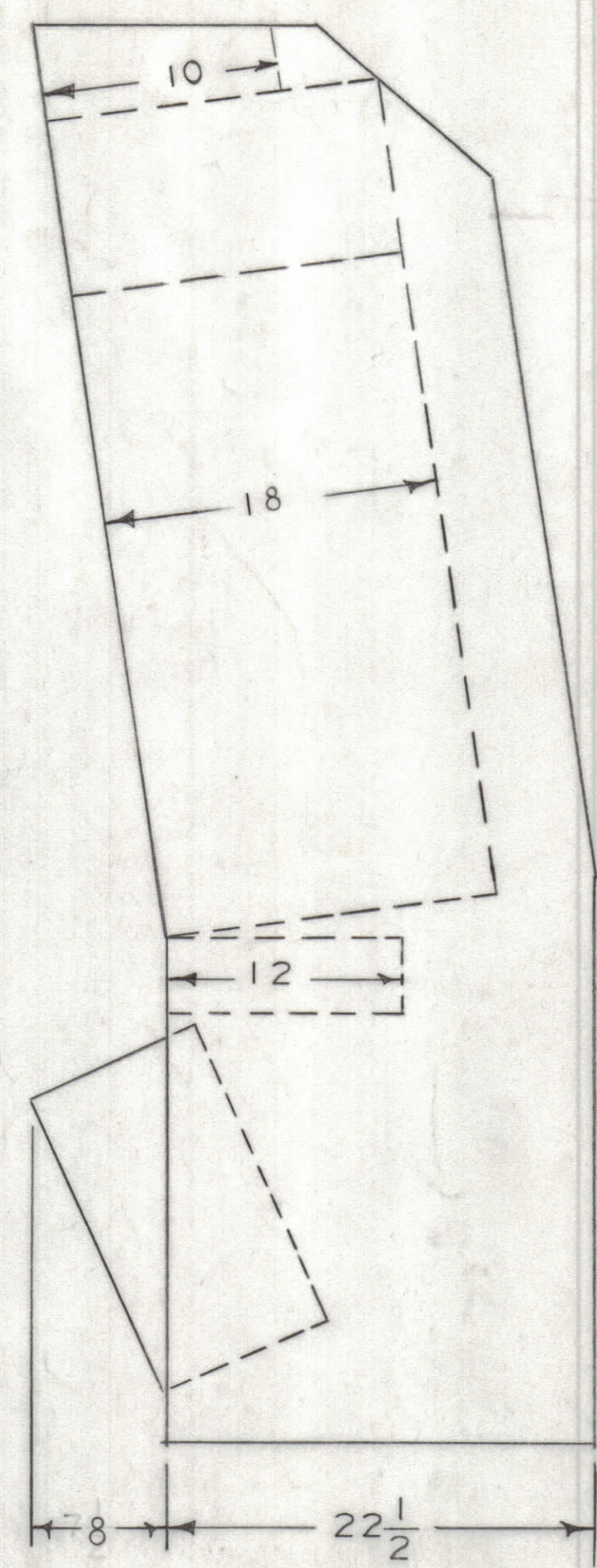
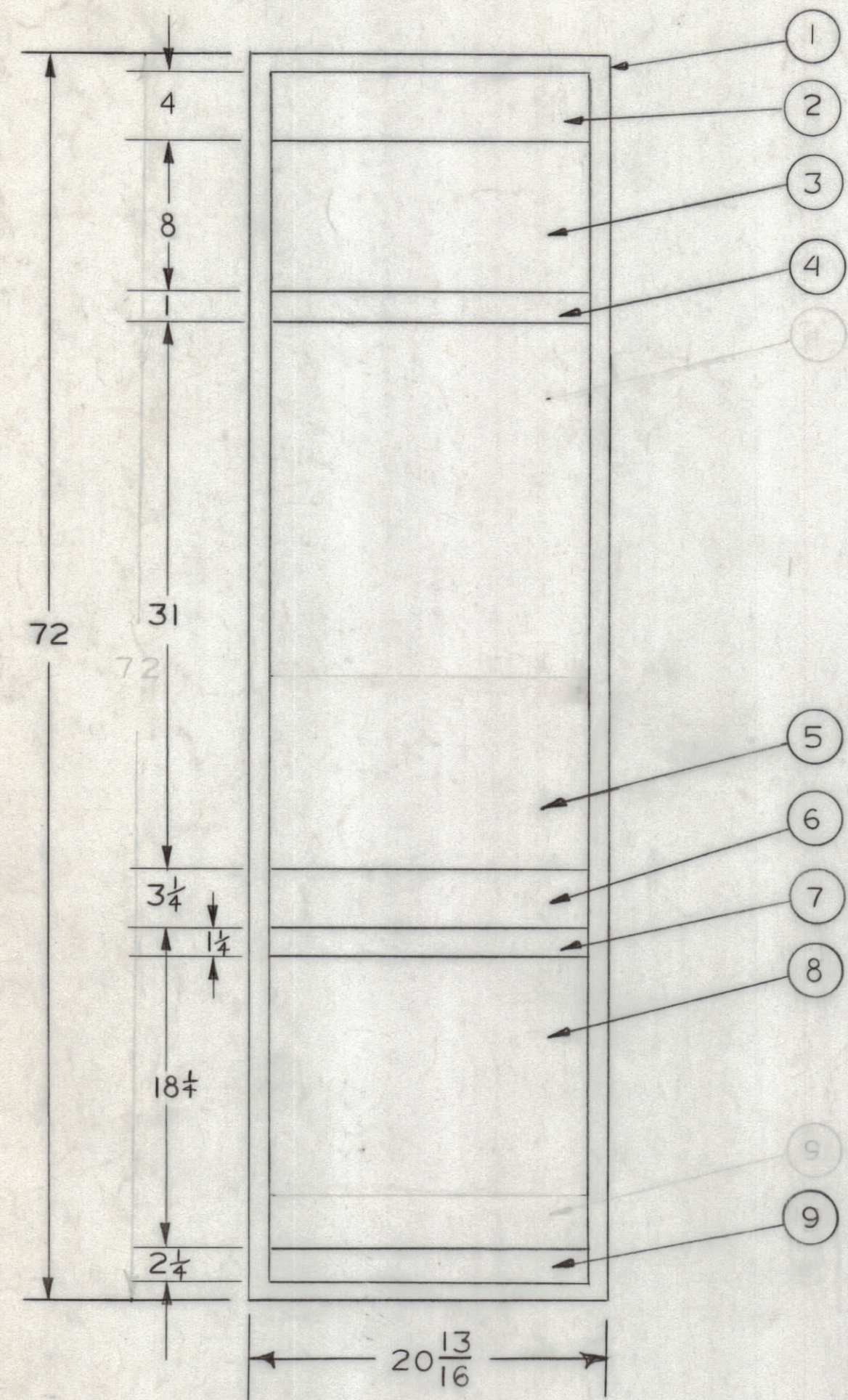

- NOTES:
1. INTERPRET IN ACCORDANCE WITH MIL-D-1000
 2. POWER INPUT: 115VAC: 1PHASE: 60 CPS
 3. POWER CONSUMPTION: 1850 WATTS TOTAL, FOR UNIT 16
 4. WEIGHT: 1062 LBS. TOTAL WEIGHT FOR UNIT 16 DOES NOT INCLUDE 153 LBS OF GFE
 5. FOR PERFORMANCE REFER TO TMC SPECIFICATION 40SI6A057
 6. FOR TECHNICAL SPECIFICATIONS, REFER TO S66-94
 7. FOR SPARES, MAINTENANCE AND INSTALLATION REFER TO INSTRUCTION MANUAL.

QTY. REQ.	NOMEN. OR DESC.	CODE IDENT.	IDENT. NO.	FIND NO.
1	PANEL, BLANK		MS8200-1	9
1	ANALYZER, SPECTRUM	16665	PA210/T3	8
1	INPUT CONT. PNL.		AX8004-3	7
1	BEAT FREQ. OSC.	99396	P/O AV1073	6
1	NOISE & FLD INTENSITY METER	99396	AV1073	5
1	FEED THRU PANEL		MS8089	4
1	ANALYZER, SPECTRUM	16665	PA210/T2A	3
1	INTERCOM PANEL		AX8007	2
1	CABINET, ELECT. EQUIP		RAK 153-16	1

QTY. REQ.	ITEM	PART NO.	DESCRIPTION	SYMBOL
LIST OF MATERIAL				
THE TECHNICAL MATERIEL CORP. MAMARONECK, NEW YORK TMC MODEL NO. RMPA-1G UNIT 20 CA 1 16C SOURCE CONTROL DWG				
SIZE	CODE	IDENT. NO.	DWG NO.	ISSUE
C	82679	ID8027		A
SCALE 1/8" = 1				SHEET 1 OF 2

1 EACH	UNIT 16A & 16C	
QTY / UNIT	MODEL USED ON	ASS'Y NO.
APPLICATION		
	CODE	
<small>NOTICE TO PERSONS RECEIVING THIS DRAWING</small> <small>THE TECHNICAL MATERIEL CORPORATION claims proprietary right in the material disclosed hereon. This drawing is issued in confidence for engineering information only and may not be reproduced or used to manufacture anything shown hereon without permission from THE TECHNICAL MATERIEL CORPORATION to the user. This drawing is loaned for mutual assistance and is subject to recall at any time.</small>		

UNLESS OTHERWISE SPECIFIED DIMENSIONS ARE IN INCHES AND INCLUDE CHEMICALLY APPLIED OR PLATED FINISHES		FINAL APPROVAL <i>[Signature]</i> DATE 3-4-68
TOLERANCES ON		MECH. DES. <i>[Signature]</i> DATE 2/4/68
DECIMALS	FRACTIONS	ELECT. DES. <i>[Signature]</i> DATE 2/27/68
.X ± .05	± 1/64	CHECKED <i>[Signature]</i> DATE 2-27-68
.XX ± .01	ANGLES	DRAWN <i>[Signature]</i> DATE 2/16/68
.XXX ± .005	± 0° -30'	
MATERIAL		
FINISH		

4

3

2

1

REVISIONS						
ZONE	LTR	DESCRIPTION	DATE	E.M.N.NO	DRAFT	CHKD APPD
	A	DELETED ITEM 7; REVISED DESCRIPTION FOR ITEM 6.	1/20/68		WRH	

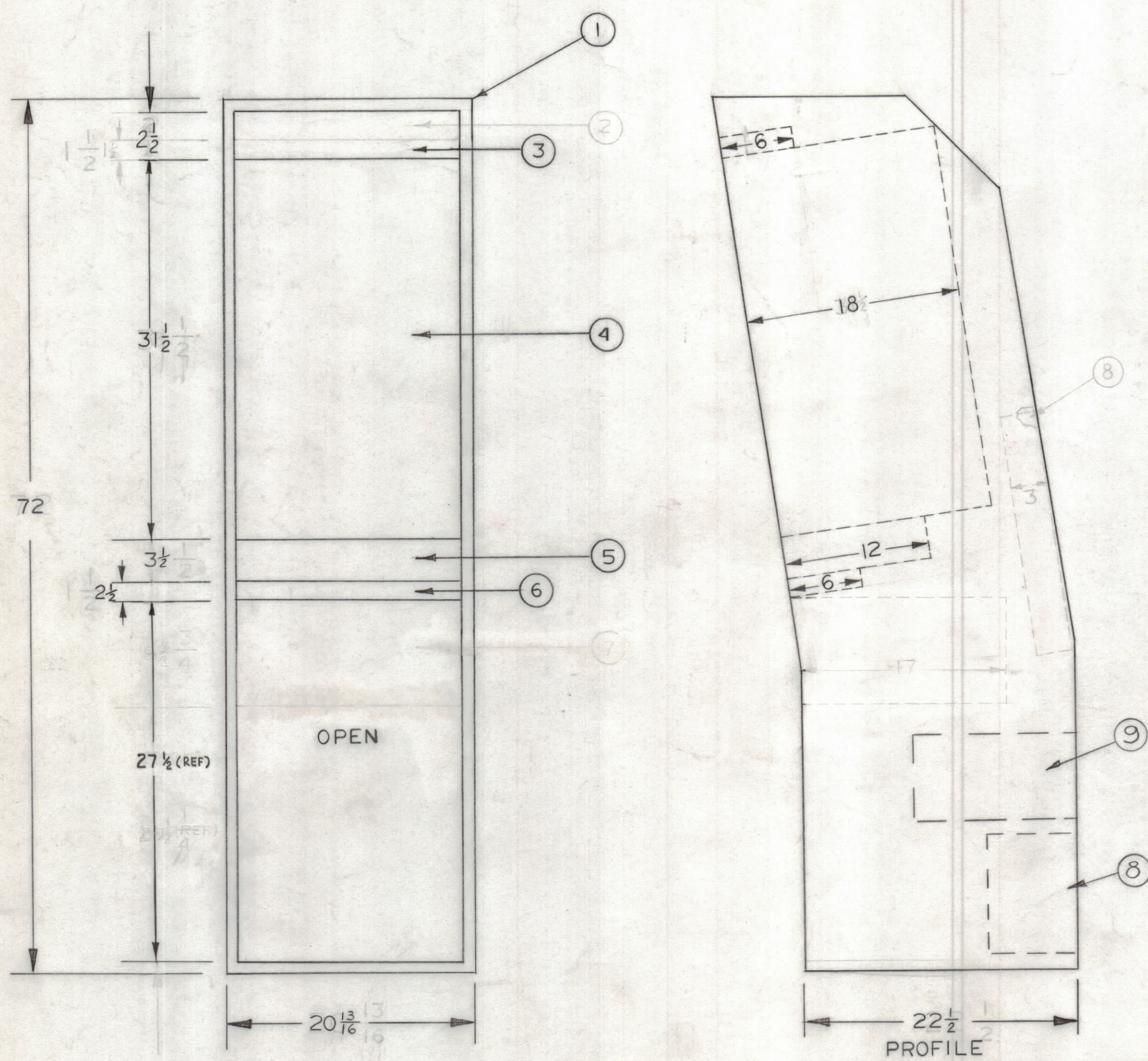

- NOTES:
1. INTERPRET IN ACCORDANCE WITH MIL-D-1000
 2. POWER INPUT: 115 VAC 1 PHASE 60 CPS.
 3. POWER CONSUMPTION: 1850 WATTS TOTAL FOR UNIT 16
 4. WEIGHT: 182 LBS. TOTAL WEIGHT FOR UNIT 16 DOES NOT INCLUDE 153 LBS OF GFE
 5. FOR PERFORMANCE REFER TO TMC SPECIFICATION 40S15A038
 6. FOR TECHNICAL SPECIFICATIONS, REFER TO S66-94
 7. FOR SPARES, MAINTENANCE AND INSTALLATION REFER TO INSTRUCTION MANUAL

QTY. REQ.	ITEM	PART NO.	DESCRIPTION	SYMBOL
1	IF SWITCHING PNL		AX8008	9
1	NF105 AUDIO BAL. CIRCUIT		AX-8021	8
	DELETED			7
1	FEED-THRU PNL & AUDIO MONITOR SELECTOR		AX8041	6
1	BEAT FREQ. OSC.		P/O AV1073	5
1	NOISE & FLD INTENSITY METER		AV-1073	4
1	FEED THRU PNL		AX8042	3
1	DELETED LINK			2
1	CABINET, ELECT. EQUIP.		RAK153-16B	1
QTY. REQ.	NOMEN. OR DESC.	CODE IDENT	IDENT. NO.	FIND NO.

QTY. REQ.	ITEM	PART NO.	DESCRIPTION	SYMBOL
LIST OF MATERIAL				
THE TECHNICAL MATERIEL CORP. MAMARONECK, NEW YORK				
TMC MODEL NO. RMPA-1 SOURCE CONTROL DWG				
MATERIAL		SIZE	CODE IDENT. NO.	DWG NO.
FINISH		C	82679	ID-8027
		SCALE 1/8" = 1		SHEET 2 OF 2

QTY / UNIT	UNIT 16 B	MODEL USED ON	ASS'Y NO.
APPLICATION			
CODE			
NOTICE TO PERSONS RECEIVING THIS DRAWING THE TECHNICAL MATERIEL CORPORATION claims proprietary right in the material disclosed hereon. This drawing is issued in confidence for engineering information only and may not be reproduced or used to manufacture anything shown hereon without permission from THE TECHNICAL MATERIEL CORPORATION to the user. This drawing is loaned for mutual assistance and is subject to recall at any time.			

UNLESS OTHERWISE SPECIFIED DIMENSIONS ARE IN INCHES AND INCLUDE CHEMICALLY APPLIED OR PLATED FINISHES

TOLERANCES ON

DECIMALS	FRACTIONS
.X ± .05	± 1/64
.XX ± .01	ANGLES
.XXX ± .005	± 0° -30'

FINAL APPROVAL: *[Signature]* DATE: 3-9-68
MECH. DES.: *[Signature]* DATE: 1/4/67
ELECT. DES.: *[Signature]* DATE: 2/27/68
CHECKED: *[Signature]* DATE: 2-27-68
DRAWN: C. Grob DATE: 2/24/67