

THE CONTENTS OF THIS DRAWING ARE THE EXCLUSIVE PROPERTY OF THE TECHNICAL MATERIEL CORP. ITS UNAUTHORIZED USE OR REPRODUCTION IN WHOLE OR IN PART IS STRICTLY FORBIDDEN.

REQ. PER UNIT

USED ON

DATE

A-2250

MODEL

ASSY. NO.

AX-236, AX-238

12-18-61

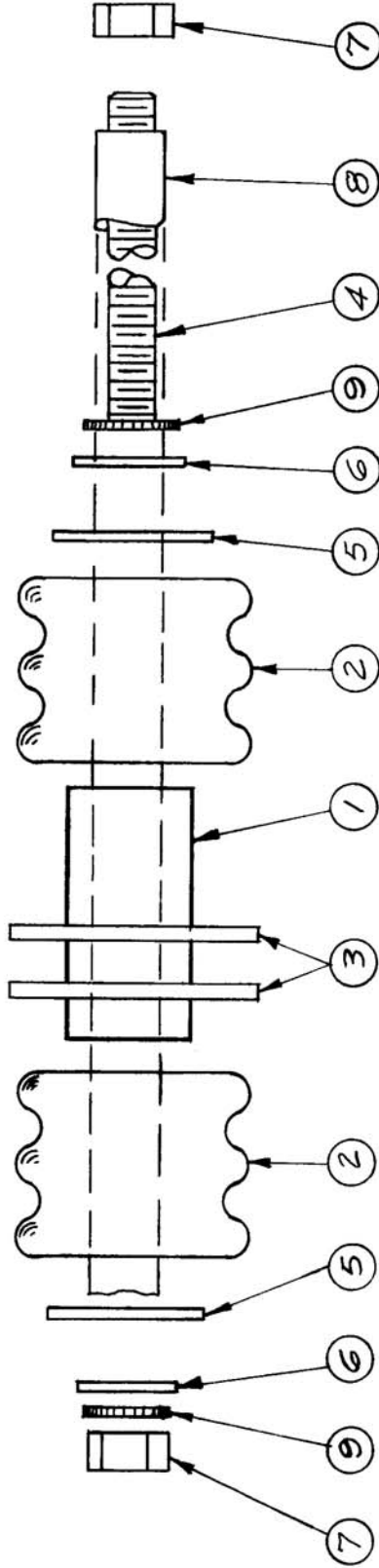

2	9	LWE10MRN	LOCKWASHER, EXT.
2	8	PX-370-4-7	TUBING, TEFLON 3" LONG
2	7	NTH1032BN12	NUT, HEX
2	6	FW10HBN	WASHER, FLAT
2	5	WA-109-56	WASHER, FIBER
1	4	SM1032BN4,00	ROD THREADED, 4" LONG
2	3	GA-117	GASKET
2	2	NS-128-1	BUSHING, INSULATED, FEMALE
1	1	PX-562-2	BUSHING, TEFLON

REQ. ITEM	PART NO.	DESCRIPTION	SYMBOL
THE TECHNICAL MATERIEL CORP. MAMARONECK, NEW YORK AX-314 ASSY (FEEDTHRU, INSULATED)			
STOCK SIZE			
MATERIAL			
W. S. <i>[Signature]</i>			
DRAWN <i>[Signature]</i> CHECKED <i>[Signature]</i> FINAL APPROVAL <i>[Signature]</i>			
TYPE & TEMPER HEAT TREAT. SPEC. <i>[Signature]</i>			
FINISH & SPEC. NO. A-2250			
ELEC. DES. APP. MECH. DES. APP.			

UNLESS OTHERWISE SPECIFIED:
 DIMENSIONS ARE IN INCHES
 TOLERANCES ON
 FRAC. $\pm 1/64$ DEC. $\pm .005$ ANGLES $\pm 1/2^\circ$

SCALE:
 MAXIMUM ALLOWABLE TOLERANCES HAVE BEEN DETERMINED AND ANY DEVIATIONS WILL BE CAUSE FOR REJECTION.
 REM VE ALL BURRS AND SHARP EDGES