

INSTRUCTIONS FOR INSTALLING THE
153905 OR 153914 SPACING
DRUM SET OF PARTS ON A MODEL 28
TYPING UNIT (LP3, LP4, LP5; BELL SYSTEM 28A)

1. GENERAL

a. The 153905 or 153914 set of parts replaces the present spacing drum on Typing Units (LP3, LP4, LP5; Bell System 28A) to permit unrestricted adjustment of the left and right hand margins especially to accommodate stationery less than $8\frac{1}{2}$ inches in width. The 153905 set of parts is used on Typing Units not equipped with the automatic CR-LF feature; the 153914 is used on Typing Units equipped with this feature.

b. The 153905 or 153914 set of parts consists of:

7	2191	Lock Washer	1	154625	Space Suppression Ring (for 153905 Set of Parts only)
4	7002	Washer	1	154626	Space Suppression Ring (for 153914 Set of Parts only)
3	151346	Screw 6-40 x 3/8 Fil.	1	154627	Spacing Drum Assembly
1	151631	Screw 6-40 x 5/16 Hex.	1	156632	Screw 6-40 x 13/32 Hex.
2	151658	Screw 6-40 x 5/16 Fil.			
1	154623	Retainer Ring			
1	154624	C.R. Ring Assembly			

c. For part numbers referred to in the following text, other than those listed in the set of parts, see Teletype Model 28 Page Printer Parts Bulletin.

2. INSTALLATION (Figure 2-16)

a. Remove the following left and right printing carriage draw wire pulley assembly retainer parts after removing spring tension from left spacing drum:

151632	Screw	(2)	7002	Washer	(2)
2191	Lock Washer	(2)			

Remove the pulley assemblies.

b. Remove the following printing track and pulley support plate retaining parts:

112626	Nut	(2)	151657 or		
2669	Lock Washer	(2)	151630	Screw	(2)
7002	Washer	(2)	2191	Lock Washer	(2)

Remove the printing track and pulley support plate.

c. Remove the carriage return latch bail assembly after first removing the 119652 retainer and disengaging the 125238 latch bail spring.

d. Remove the following dashpot plunger assembly transfer slide stud retainers.

112626	Nut	(1)	2669	Lock Washer	(1)
--------	-----	-----	------	-------------	-----

e. Remove the following draw wire rope retaining parts from the spacing drum:

151618	Screw	(2)	7002	Washer	(2)
2191	Lock Washer	(2)			

f. Remove the 150206 spacing sleeve, hold up the spacing pawls, push dashpot plunger to the right and pull the spacing drum slightly forward. Remove the dashpot plunger assembly and entirely remove the spacing drum.

g. Dismantle the spacing drum and discard all parts except the following:

150798	Ratchet	(1)	150838	Retainer Ring	(1)
--------	---------	-----	--------	---------------	-----

The 151346 screws and 2191 lock washers supplied replace similar parts present.

h. Assemble the spacing drum as shown in Figure 1.

i. Reassemble unit by reversing procedure used in removal.

3. ADJUSTMENTS AND LUBRICATION

For standard adjustment and lubrication procedure, refer to the Model 28 Printer Adjustment and Lubrication Bulletin. Check the following.

a. Adjustments

- (1) Oscillating Rail Slide Position
- (2) Carriage Wire Rope
- (3) Carriage Return Spring Tension
- (4) Carriage Return Latch Bail
- (5) Carriage Return Lever
- (6) Printing Carriage Position
- (7) Left Hand Margin
- (8) Right Margin (for 153905 set of parts)
- (9) Automatic Carriage Return Arm (for 153914 set of parts)

b. Lubrication

Apply oil to the following points as specified:

- (1) Stop Arm Roller Bearing (2 drops)
- (2) Spacing Drum Shaft (saturate)
- (3) Transfer Slide Engaging Surface (2 drops)

- 3 -
(5816S)

- (4) Carriage Return Latch Bail engaging surfaces (2 drops each).
- (5) Spacing Drum Ratchet Teeth. (Thin film)
- (6) Spacing Drum Cable Grooves (2 drops each).

* * *

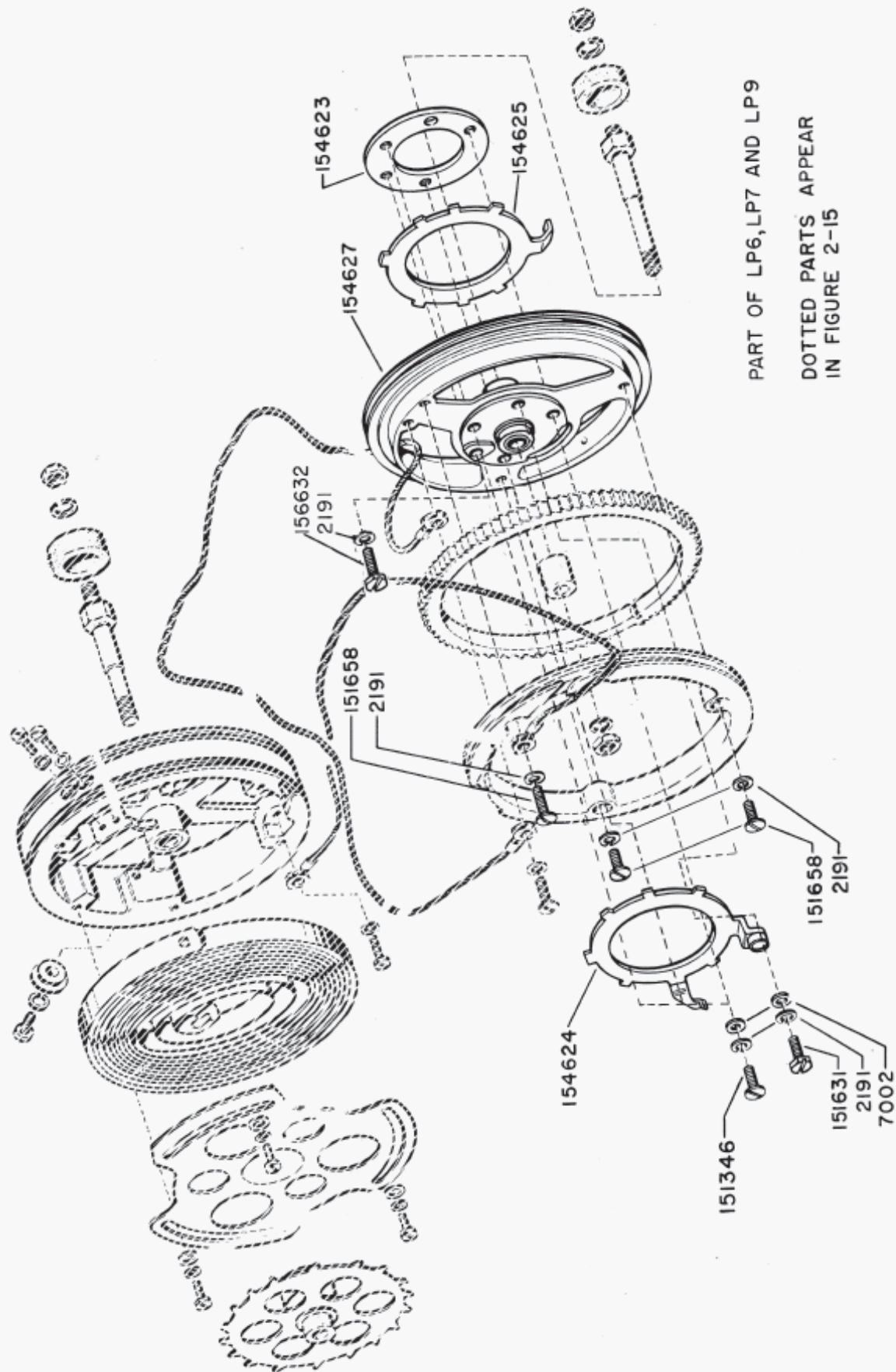

PART OF LP6, LP7 AND LP9
 DOTTED PARTS APPEAR
 IN FIGURE 2-15

FIGURE 2-16 SPACING DRUM MECHANISM